

8118, HUNTERS RIDGE, NEWPORT, MI, 48166

https://tuckerbenner.com

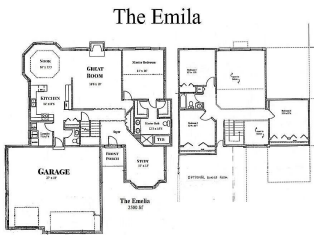
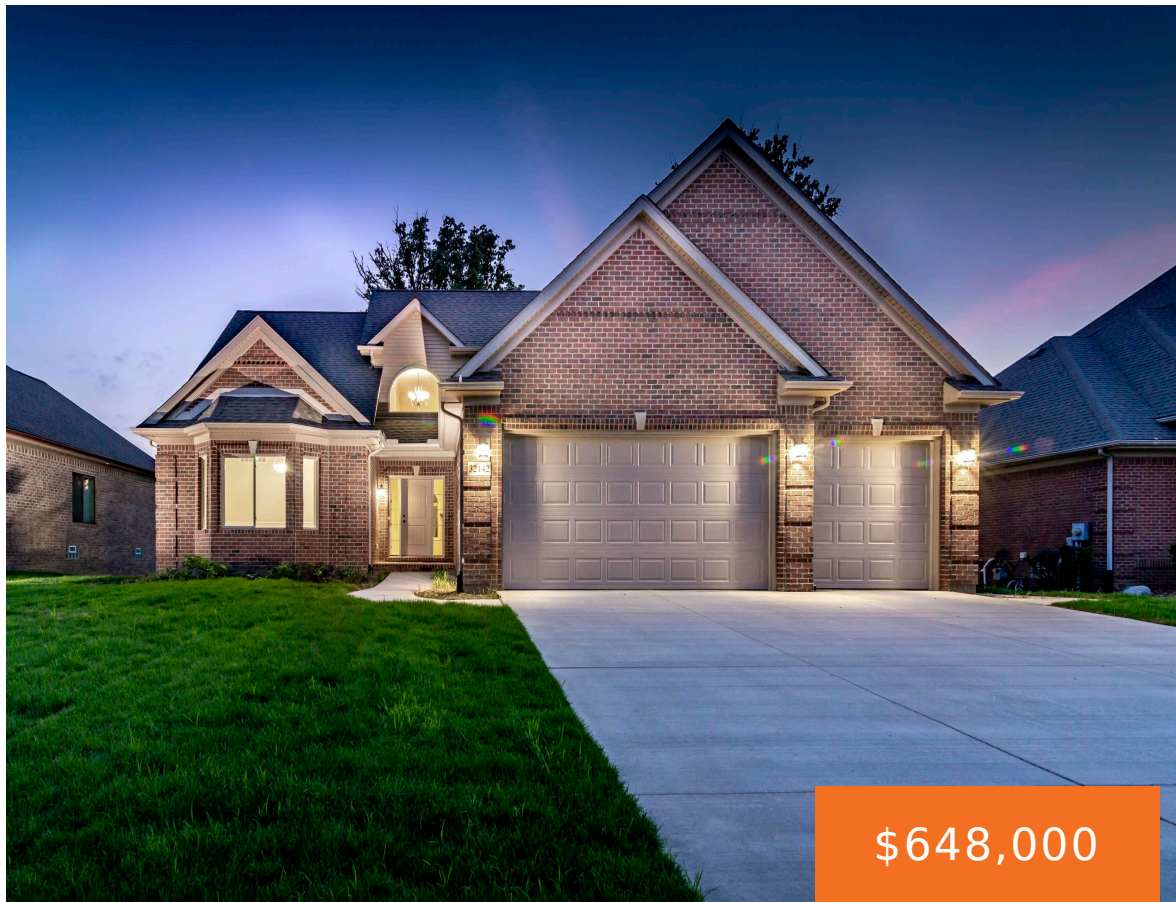

”Emilia” 2-Story home with a two-car attached garage. HOME NOT BUILT YET. Sales price most commonly includes, but is not limited to Jeldwen or equivalent windows, Premium Architectural shingles, 8’ Poured basement wall height with exterior waterproofing membrane & egress window, 90Plus Energy efficient direct vent furnace, Custom maple or oak cabinets & vanities, granite [...]

- 4 beds
- 3 baths
- Single Family Residence
- Residential
- Active
- 2700 sq ft



Call us now

Phone: (231)730-8781
Email: tuckerbennerteam@gmail.com
Address: 2747 Lakeshore Drive, Twin Lake, MI 49457

Basics

Category: Residential

Status: Active

Bathrooms: 3 baths

Lot size: 0.26 sq ft

Subdivision Name: Eagle Point Site Condo

Lot Size Acres: 0.26 acres

County: Monroe

Type: Single Family Residence

Bedrooms: 4 beds

Area: 2700 sq ft

Year built: 2024

Bathrooms Full: 2

Rooms Total: 9

Bathrooms Half: 1

Building Details

Construction Materials: Vinyl Siding, Brick

Sewer: Public Sewer

Stories: 2

Architectural Style: Colonial

Heating: Forced Air, Natural Gas

Basement: Daylight, Full

Amenities & Features

Laundry Features: Laundry Room, Main Level, Washer Hookup

Parking Features: Attached, Concrete, Driveway

WaterSource: Public

Utilities: Natural Gas Connected

Garage Spaces: 2

Cooling: Central Air

Fees & Taxes

Tax Assessed Value: \$22,234

Association Fee: \$850

Tax Annual Amount: \$699

Association Fee Frequency: Annually

Tax Year: 2023

Call us now

School Information

High School District: Jefferson

Miscellaneous

Road Surface Type: Paved

CrossStreet: Rolling Meadows / Swan Creek

Listing Terms: Cash, VA Loan, Other, Conventional

Call us now