

8187, HUNTERS RIDGE, NEWPORT, MI, 48166

<https://tuckerbenner.com>

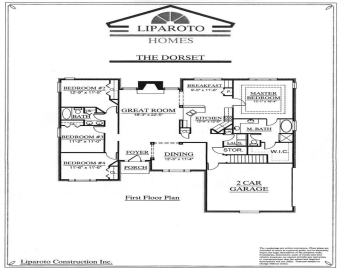

The "Dorset" is a ranch style home with a 2-car attached garage. Sales price commonly includes, but is not limited to premium Architectural shingles, 90plus Energy efficient direct vent furnace, custom maple or oak cabinets & vanities, granite countertops & more. HOME NOT BUILT YET. OPTION TO SELECT DIFFERENT FLOORPLAN AVAILABLE. Prices are estimates & [...]

- 3 beds
- 2 baths
- Single Family Residence
- Residential
- Active
- 2400 sq ft



Basics



Call us now

Phone: (231)730-8781
 Email: tuckerbennerteam@gmail.com
 Address: 2747 Lakeshore Drive, Twin Lake, MI 49457



Category: Residential

Status: Active

Bathrooms: 2 baths

Lot size: 0.33 sq ft

Subdivision Name: Eagle Pointe Sub Division

Lot Size Acres: 0.33 acres

County: Monroe

Type: Single Family Residence

Bedrooms: 3 beds

Area: 2400 sq ft

Year built: 2025

Bathrooms Full: 2

Rooms Total: 11

Building Details

Building Area Total: 2400 sq ft **Construction Materials:** Brick, Vinyl Siding

Architectural Style: Ranch

Sewer: Public Sewer

Heating: Forced Air

Stories: 1

Basement: Full

Amenities & Features

Laundry Features: Main Level

Parking Features: Attached

Garage Spaces: 2

WaterSource: Public

Fees & Taxes

Tax Assessed Value: \$15,300

Association Fee Frequency: Annually

Association Fee: \$850

Tax Year: 2023

Tax Annual Amount: \$752

School Information

High School District: Jefferson



Call us now

Phone: (231)730-8781

Email: tuckerbennerteam@gmail.com

Address: 2747 Lakeshore Drive, Twin Lake, MI 49457



Miscellaneous

Road Surface Type: Paved

CrossStreet: Cobblestone / Rolling Meadows

Listing Terms: Cash, VA Loan, Conventional



Call us now

Phone: (231)730-8781

Email: tuckerbennerteam@gmail.com

Address: 2747 Lakeshore Drive, Twin Lake, MI 49457

