

# 82136, 100TH ST, BYRON CENTER, MI, 49315

<https://tuckerbenner.com>

Kent County Web Map

April 24, 2024

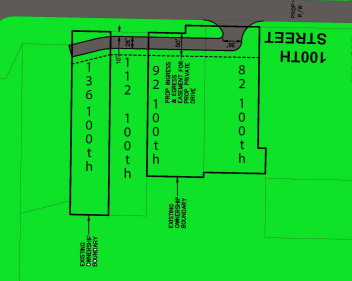
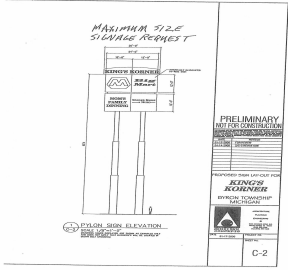

\$25

The north two parcels of this property are Masterplanned Commercial. The Township Planner and Zoning Administrator have indicated they would support rezoning to commercial for the right commercial user. Maximum building size of approximately 9500sf, or RS - Suburban- Residential to allow for up to 2 separate duplex lots and one single family lot. The sewer [...]

- 0 baths
- Retail/Commercial
- Commercial Lease
- Active



## Basics

**Category:** Commercial Lease

**Status:** Active

**Lot size:** 3.58 sq ft

**Business Type:** Restaurant, Professional Service, Professional/Office, Retail

**Type:** Retail/Commercial

**Bathrooms:** 0 baths

**Lot Size Acres:** 3.58 acres

**County:** Kent



### Call us now

Phone: (231)730-8781  
 Email: [tuckerbenner@gmail.com](mailto:tuckerbenner@gmail.com)  
 Address: 2747 Lakeshore Drive, Twin Lake, MI 49457



---

## Building Details

**Building Area Total:** 14000 sq ft

**Roof:** Concrete

**Sewer:** Public Sewer

**Number Of Buildings:** 1

---

## Amenities & Features

**Utilities:** None Connected

**Fireplaces Total:** 1

**WaterSource:** Public

---

## School Information

**High School District:** Byron Center

---

## Miscellaneous

**CrossStreet:** Division and 100th



### Call us now

Phone: (231)730-8781

Email: [tuckerbennerteam@gmail.com](mailto:tuckerbennerteam@gmail.com)

Address: 2747 Lakeshore Drive, Twin Lake, MI 49457

