

8232, RAMSDELL, ROCKFORD, MI, 49341

https://tuckerbenner.com

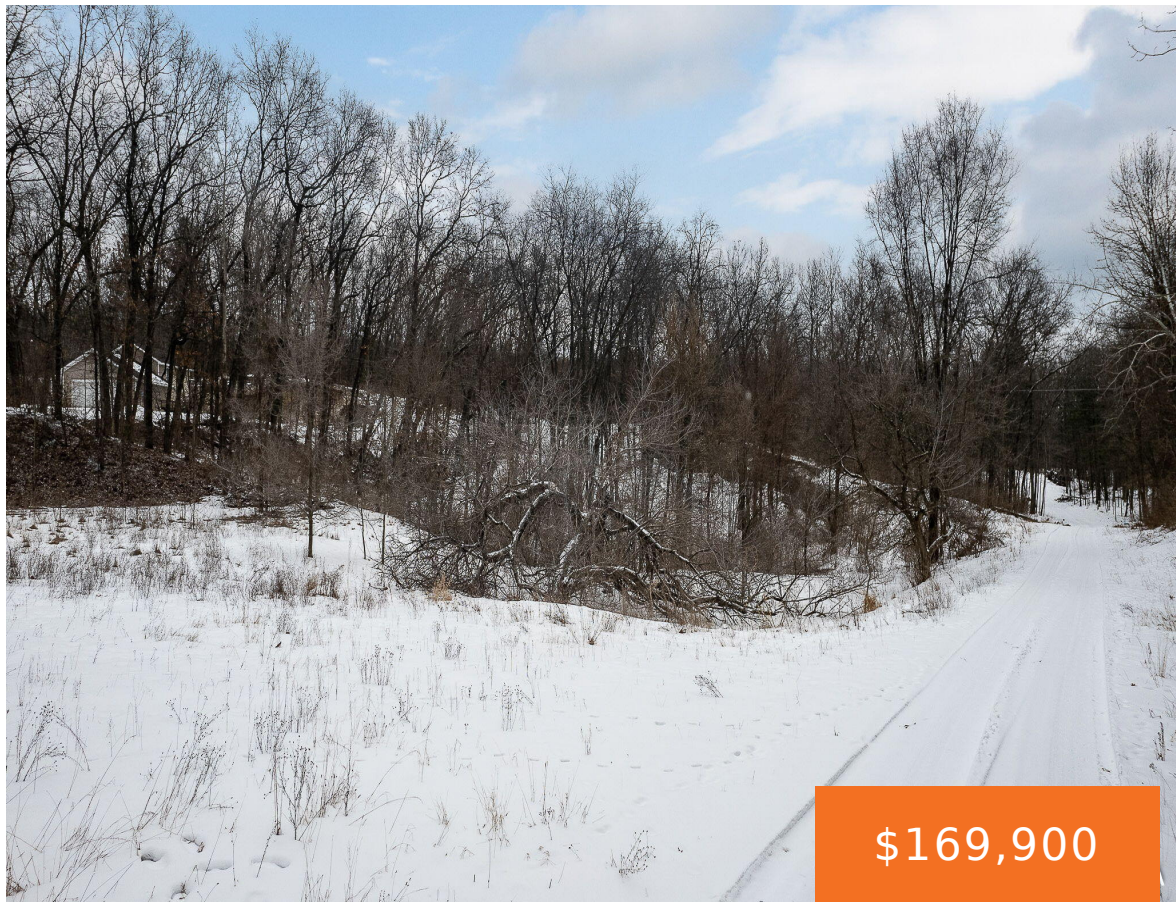

Build your dream home on this stunning wooded lot, just minutes from downtown Rockford! Surrounded by nature and wildlife, this private retreat offers the perfect blend of seclusion and convenience. Picture yourself waking up to peaceful wooded views while staying close to great shops and dining. Don't miss this rare opportunity—come walk the property and [...]

- 0 baths
- Lot
- Land
- Active

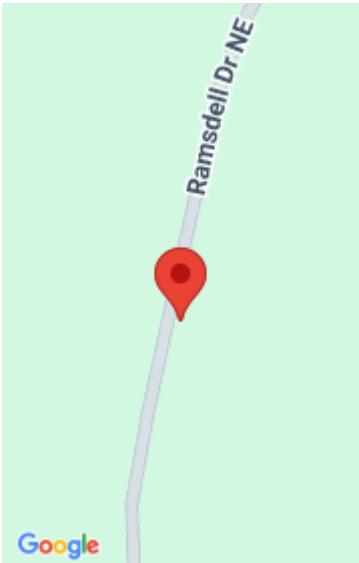

Basics

Category: Land

Status: Active

Lot size: 8.95 sq ft

County: Kent

Type: Lot

Bathrooms: 0 baths

Lot Size Acres: 8.95 acres

Amenities & Features

Utilities: Broadband, None

Lot Features: Rolling Hills, Buildable, Wooded

Fees & Taxes

Tax Assessed Value: \$35,721

Tax Year: 2024

Tax Annual Amount: \$1,759.72

School Information

High School District: Rockford

Miscellaneous

Road Surface Type: Paved

CrossStreet: 10 mile and Ramsdell Dr NE

Listing Terms: Cash, Conventional

Call us now