

833, OTTAWA, GRAND RAPIDS, MI, 49503

https://tuckerbenner.com

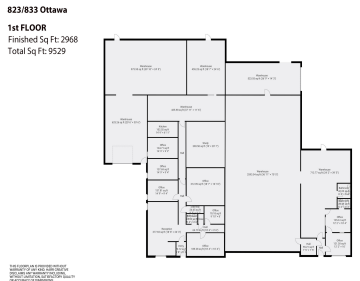

Available for lease. Explore this exceptional commercial property offering a seamless blend of modern office space and expansive industrial warehouse, complete with a convenient loading dock. Located at 823-833 Ottawa Ave NW, this versatile facility is ideal for businesses looking to optimize operations with ample space for both administrative functions and logistical needs. Featuring over [...]

- 0 baths
- Industrial
- Commercial Lease
- Active



---

# Basics

**Category:** Commercial Lease    **Type:** Industrial  
**Status:** Active    **Bathrooms:** 0 baths  
**Lot size:** 0.29 sq ft    **Year built:** 1947  
**Lot Size Acres:** 0.29 acres    **Business Type:** Auto Service, Professional Service, Professional/Office, Storage, Manufacturing, Distribution  
**County:** Kent

---

# Building Details

**Building Area Total:** 9529 sq ft    **Construction Materials:** Block  
**Heating:** Forced Air, Radiant    **Building Features:** Bath Common Area, Barrier Free  
**Roof:** Rubber    **Foundation Details:** Concrete Perimeter, Block  
**Number Of Buildings:** 1

---

# Amenities & Features

**Parking Total:** 8    **Utilities:** Phone Available, Natural Gas Available, Electricity Available, Cable Available, Phone Connected, Natural Gas Connected, Electricity Connected, Cable Connected, Extra Well  
**Parking Features:** Asphalt, Driveway, Concrete    **Fireplaces Total:** 1  
**Cooling:** Central Air

---

# School Information

**High School District:** Grand Rapids

---

# Miscellaneous

Call us now

**CrossStreet:** Mason

**Call us now**



Address: 2747 Lakeshore Drive, Twin Lake, MI 49457

