

**COMMERCIAL SPACE  
FOR LEASE**  
(313) 717-7996  
ckennedy@gobeal.com  
GOBEAL.COM  
KENNEDY GOBEAL REAL PROPERTIES

**\$11.39**

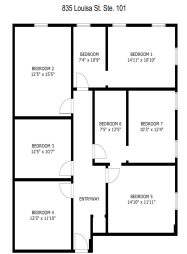

- 0 baths
- Office
- Commercial Lease
- Active

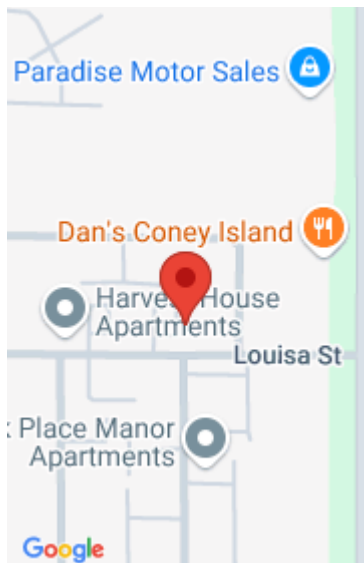

# Basics

**Category:** Commercial Lease

**Status:** Active

**Lot size:** 0.74 sq ft

**Lot Size Acres:** 0.74 acres

**County:** Ingham

**Type:** Office

**Bathrooms:** 0 baths

**Year built:** 1973

**Business Type:** Professional/Office

# Building Details

**Building Area Total:** 632 sq ft

**Heating:** Forced Air

**Sewer:** Public Sewer

**Number Of Buildings:** 1

# Amenities & Features

**Utilities:** None

**Fireplaces Total:** 1

**WaterSource:** Public

# Fees & Taxes

**Tax Assessed Value:** \$290,000

**Tax Year:** 2023

# School Information

**High School District:** Lansing

# Miscellaneous

Call us now

**CrossStreet:** Jolly Road.

**Call us now**



Phone: (231)730-8781  
Email: [tuckerbennerteam@gmail.com](mailto:tuckerbennerteam@gmail.com)  
Address: 2747 Lakeshore Drive, Twin Lake, MI 49457

