

835, LOUISA, LANSING, MI, 48911

https://tuckerbenner.com

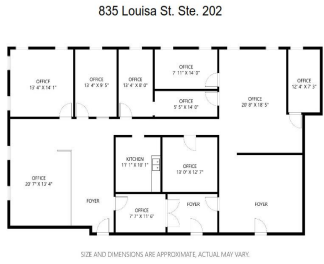

\$15.63



835 Louisa St. in Lansing, MI 48911 offers an excellent commercial office space for rent, providing a blank canvas for you to add your personal finishing touches. This cozy yet versatile space is available which includes trash removal services for your convenience. Additionally, the property offers ample onsite parking, ensuring hassle-free access for you and [...]

- 0 baths
- Office
- Commercial Lease
- Active



Basics

Category: Commercial Lease
Status: Active
Lot size: 0.74 sq ft
Lot Size Acres: 0.74 acres
County: Ingham

Type: Office
Bathrooms: 0 baths
Year built: 1973
Business Type: Professional/Office



Call us now

Phone: (231)730-8781
 Email: tuckerbennerteam@gmail.com
 Address: 2747 Lakeshore Drive, Twin Lake, MI 49457



Building Details

Building Area Total: 192 sq ft

Heating: Forced Air

Sewer: Public Sewer

Number Of Buildings: 1

Amenities & Features

Utilities: None

Fireplaces Total: 1

WaterSource: Public

Fees & Taxes

Tax Assessed Value: \$290,000

Tax Year: 2023

School Information

High School District: Lansing

Miscellaneous

CrossStreet: Jolly Road



Call us now

Phone: (231)730-8781

Email: tuckerbennerteam@gmail.com

Address: 2747 Lakeshore Drive, Twin Lake, MI 49457

