

8428, JASONVILLE, CALEDONIA, MI, 49316

<https://tuckerbenner.com>

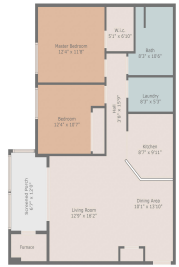

Floor Plan

Cyndi Fein



Cyndi Fein



Cyndi Fein

Move In Ready Condo Now Available with immediate occupancy at close. This condo boasts 2 spacious bedrooms, primary bedroom has a huge walk-in closet, enclosed and insulated balcony, in unit laundry, jetted tub, and inviting open floor plan with plan with plenty of space for entertaining. So many updates including new carpet throughout (25), new [...]

- 2 beds
- 1 bath
- Condominium
- Residential
- Active
- 982 sq ft



Basics



Call us now

Phone: (231)730-8781
 Email: tuckerbennerteam@gmail.com
 Address: 2747 Lakeshore Drive, Twin Lake, MI 49457



Category: Residential

Status: Active

Bathrooms: 1 bath

Lot size: 0.1 sq ft

Bathrooms Full: 1

Rooms Total: 6

Type: Condominium

Bedrooms: 2 beds

Area: 982 sq ft

Year built: 1997

Lot Size Acres: 0.1 acres

County: Kent

Building Details

Building Area Total: 982 sq ft

Architectural Style: Other

Heating: Forced Air

Basement: Other

Construction Materials: Vinyl Siding

Sewer: Public Sewer

Stories: 1

Amenities & Features

Laundry Features: Electric Dryer Hookup, Laundry Room, Washer Hookup

Utilities: Natural Gas Available, Electricity Available, Cable Available, Natural Gas Connected, Cable Connected, Public Water, Public Sewer, Broadband, High-Speed Internet

Parking Features: Garage Faces Side, Detached

WaterSource: Public

Interior Features: Ceiling Fan(s), Garage Door Opener, Water Softener/Owned, Whirlpool Tub

Window Features: Screens, Insulated Windows

Cooling: Central Air

Pool Features: Outdoor/Inground

Association Amenities: Clubhouse, Fitness Center, Pool

Garage Spaces: 1

Appliances: Washer, Refrigerator, Range, Oven, Microwave, Dryer, Disposal, Dishwasher

Lot Features: Level, Sidewalk, Cul-De-Sac

Exterior Features: Balcony, Scrn Porch

Fees & Taxes



Call us now

Phone: (231)730-8781

Email: tuckerbennerteam@gmail.com

Address: 2747 Lakeshore Drive, Twin Lake, MI 49457



Tax Assessed Value: \$35,922 **Association Fee Frequency:** Monthly

Association Fee: \$275

Tax Year: 2024

Tax Annual Amount: \$1,083

Association Fee Includes: Water, Trash, Snow Removal,
Sewer, Lawn/Yard Care

School Information

High School District: Caledonia

Miscellaneous

Road Surface Type: Paved

CrossStreet: 84th/Cherry Valley

Listing Terms: Rural Development, Conventional



Call us now

Phone: (231)730-8781

Email: tuckerbennerteam@gmail.com

Address: 2747 Lakeshore Drive, Twin Lake, MI 49457

