

8478, COBBLESTONE, NEWPORT, MI, 48166

https://tuckerbenner.com

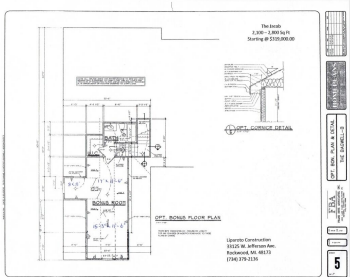
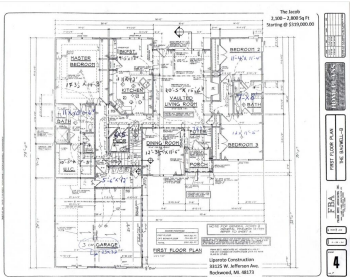

The "Jacob" is a ranch style home with a 2-car attached garage. Sales price commonly includes, but is not limited to premium Architectural shingles, 90plus Energy efficient direct vent furnace, custom maple or oak cabinets & vanities, granite countertops & more. Additional 300-600sf bonus room upgrade available. HOME NOT BUILT YET. OPTION TO SELECT DIFFERENT [...]

- 3 beds
- 3 baths
- Single Family Residence
- Residential
- Active
- 2100 sq ft

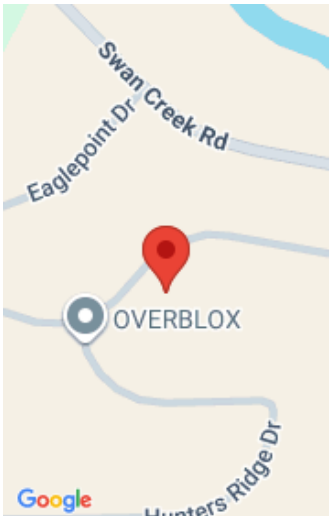

Call us now

Phone: (231)730-8781  
Email: tuckerbennerteam@gmail.com  
Address: 2747 Lakeshore Drive, Twin Lake, MI 49457

# Basics

**Category:** Residential  
**Status:** Active  
**Bathrooms:** 3 baths  
**Lot size:** 0.05 sq ft  
**Subdivision Name:** Eagle Pointe Subdivision  
**Lot Size Acres:** 0.05 acres  
**County:** Monroe

**Type:** Single Family Residence  
**Bedrooms:** 3 beds  
**Area:** 2100 sq ft  
**Year built:** 2025  
**Bathrooms Full:** 2  
**Rooms Total:** 12  
**Bathrooms Half:** 1

# Building Details

**Building Area Total:** 2100 sq ft  
**Architectural Style:** Ranch  
**Heating:** Forced Air  
**Basement:** Full

**Construction Materials:** Brick, Vinyl Siding  
**Sewer:** Public Sewer  
**Stories:** 1

# Amenities & Features

**Laundry Features:** Main Level  
**Garage Spaces:** 2  
**Cooling:** Central Air

**Parking Features:** Attached  
**WaterSource:** Public

# Fees & Taxes

**Tax Assessed Value:** \$19,977  
**Association Fee:** \$850  
**Tax Annual Amount:** \$941

**Association Fee Frequency:** Annually  
**Tax Year:** 2023

Call us now

---

# School Information

**High School District:** Jefferson

---

# Miscellaneous

**Road Surface Type:** Paved **CrossStreet:** Swan Creek / Hunters Ridge

**Listing Terms:** Cash, VA Loan, Conventional

**Call us now**