

8883, 10TH, KALAMAZOO, MI, 49009

<https://tuckerbenner.com>



Do not miss out on the opportunity to own 2 acres in Texas Township, Portage Schools! This three bedroom property is ready for a new owner, updates and to be brought back to life! The unfinished basement presents potential for additional living space. 720 sqft general purpose pole barn with 20ft ceiling and 540 sqft [...]

- 3 beds
- 2 baths
- Single Family Residence
- Residential
- Active
- 1716 sq ft

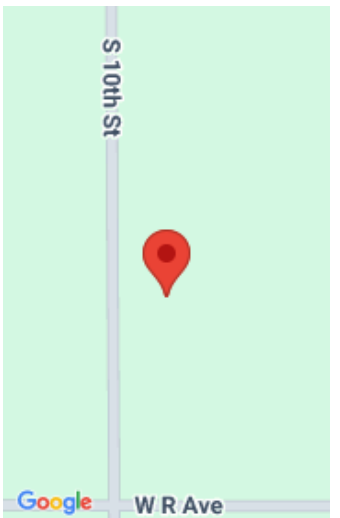

Call us now

Phone: (231)730-8781
Email: tuckerbennerteam@gmail.com
Address: 2747 Lakeshore Drive, Twin Lake, MI 49457



Basics

Category: Residential

Status: Active

Bathrooms: 2 baths

Lot size: 1.99 sq ft

Bathrooms Full: 1

Rooms Total: 7

Bathrooms Half: 1

Type: Single Family Residence

Bedrooms: 3 beds

Area: 1716 sq ft

Year built: 1993

Lot Size Acres: 1.99 acres

County: Kalamazoo

Building Details

Building Area Total: 1716 sq ft

Architectural Style: Ranch

Heating: Forced Air

Roof: Composition, Shingle

Construction Materials: Vinyl Siding

Sewer: Septic Tank

Stories: 1

Basement: Full

Amenities & Features

Laundry Features: Main Level

Parking Features: Garage Faces Front, Attached

Fireplace Features: Living Room

Garage Spaces: 2

WaterSource: Well

Lot Features: Level

Fireplaces Total: 1

Fees & Taxes

Tax Assessed Value: \$96,520

Tax Year: 2025

Tax Annual Amount: \$3,714

Call us now



Phone: (231)730-8781

Email: tuckerbennerteam@gmail.com

Address: 2747 Lakeshore Drive, Twin Lake, MI 49457



School Information

High School District: Portage

Miscellaneous

Road Surface Type: Paved

CrossStreet: W Q Ave and W R Ave

Listing Terms: Cash, Conventional

Call us now



Phone: (231)730-8781

Email: tuckerbennerteam@gmail.com

Address: 2747 Lakeshore Drive, Twin Lake, MI 49457

