

901, ADELAIDE, MUSKEGON, MI, 49441

https://tuckerbenner.com

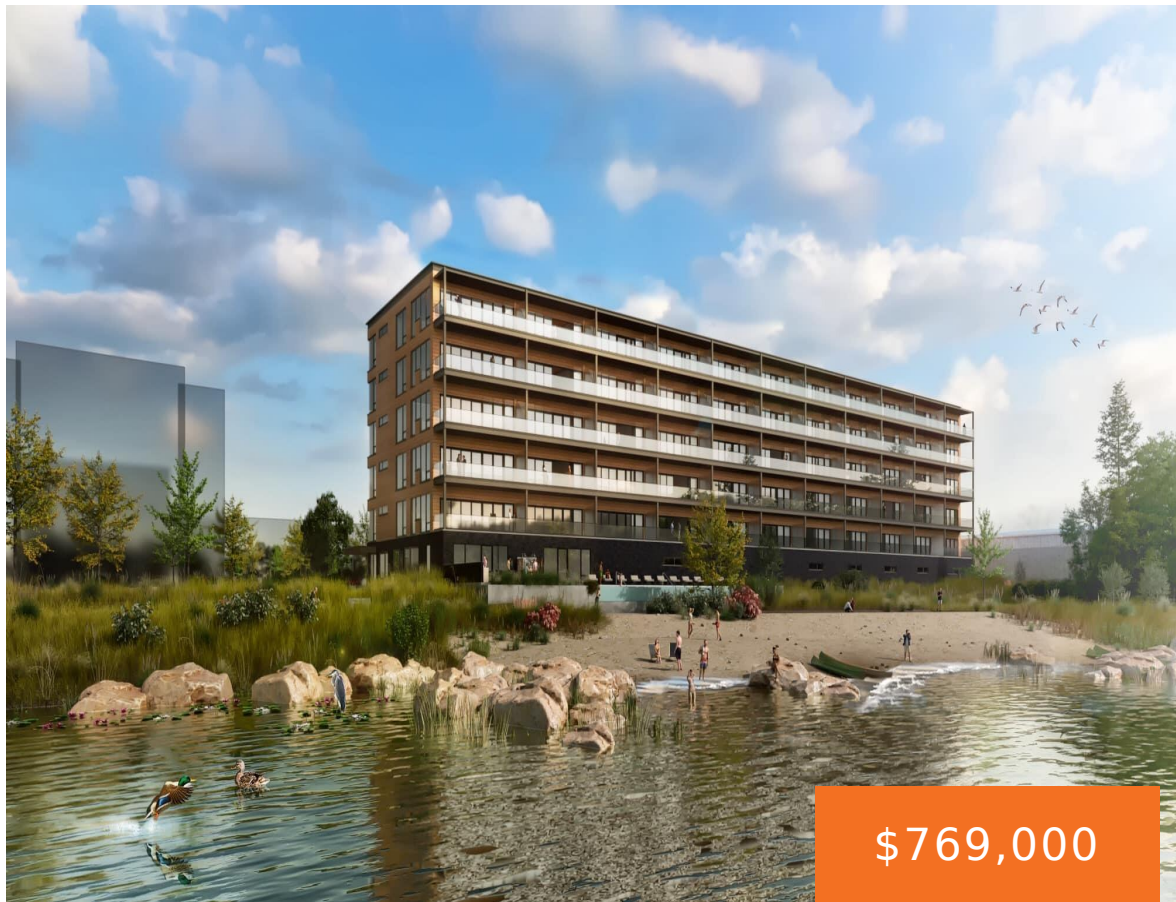

Welcome to Adelaide Pointe where you'll find the best of everything! Michigan's first Mass Timber Condos and greenest condos in MI. This condo, situated on Muskegon Lake, will have amazing sunset views. This gorgeous 2 bedroom (3rd bedroom upgrade available) and 2 bath 1,484 sq ft condo boasts an open floor plan with kitchen island, [...]

- 3 beds
- 2 baths
- Condominium
- Residential
- Active
- 1484 sq ft

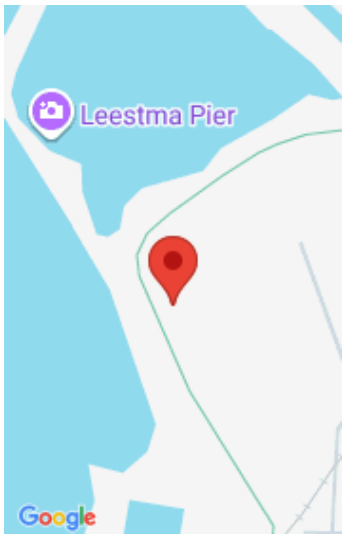

Call us now

Phone: (231)730-8781
Email: tuckerbennerteam@gmail.com
Address: 2747 Lakeshore Drive, Twin Lake, MI 49457

Basics

Category: Residential

Status: Active

Bathrooms: 2 baths

Lot size: 0 sq ft

Bathrooms Full: 2

Rooms Total: 8

Type: Condominium

Bedrooms: 3 beds

Area: 1484 sq ft

Year built: 2023

Lot Size Acres: 0 acres

County: Muskegon

Building Details

Building Area Total: 1484 sq ft

Architectural Style: Other

Heating: Forced Air, Natural Gas

Basement: Other

Construction Materials: Other

Sewer: Public Sewer

Stories: 1

Amenities & Features

Pool Features: Outdoor/Inground

Parking Features: Attached

Garage Spaces: 1

Interior Features: Elevator, Kitchen Island

Association Amenities: Pets Allowed, Fitness Center, Meeting Room, Pool

Waterfront Features: All Sports, Dock, Shared Frontage

WaterSource: Public

Cooling: Central Air

Fees & Taxes

Association Fee Frequency: Monthly

Association Fee: \$298

Association Fee Includes: Snow Removal, Lawn/Yard Care

Call us now

School Information

High School District: Muskegon

Miscellaneous

CrossStreet: W Western & Adelaide Circle

Listing Terms: Cash, Conventional

Call us now