

901, ADELAIDE, MUSKEGON, MI, 49441

https://tuckerbenner.com

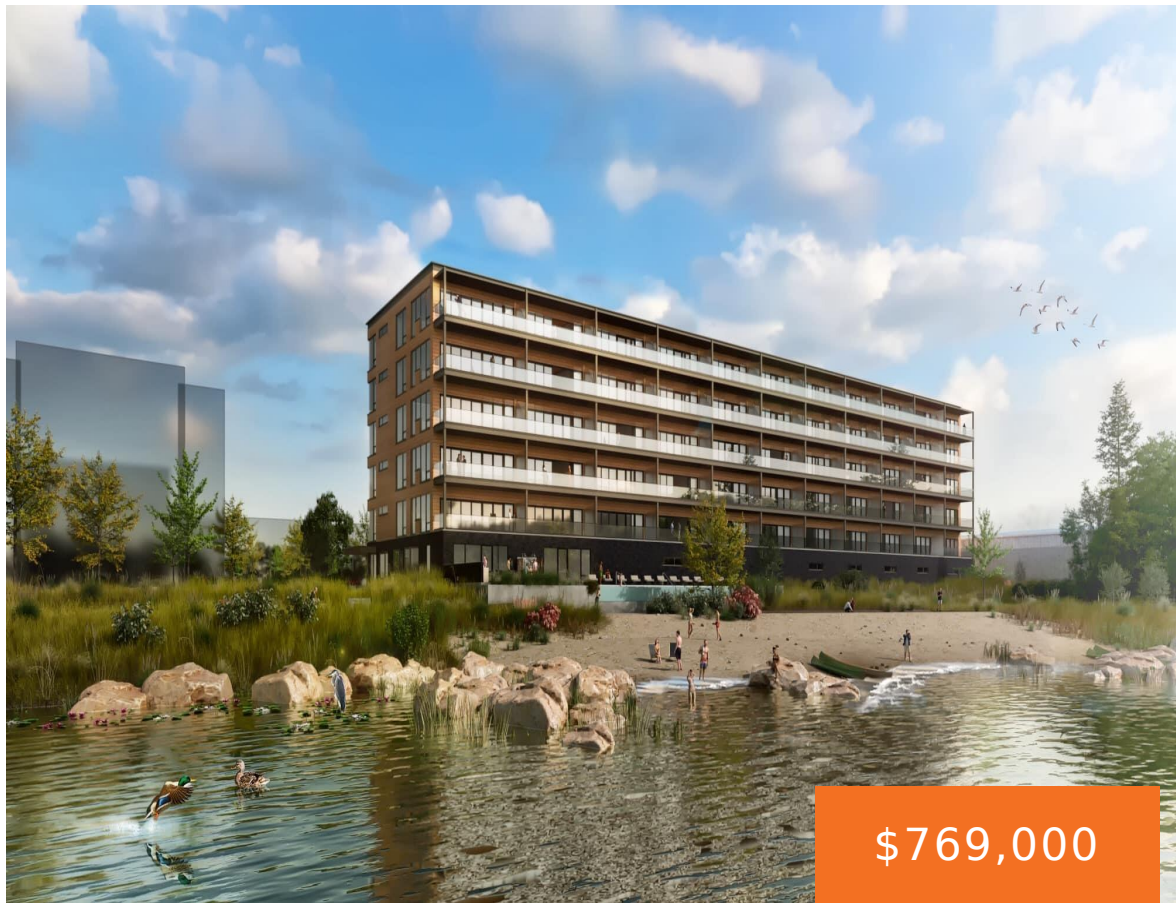

Welcome to Adelaide Pointe where you'll find the best of everything! Michigan's first Mass Timber Condos and greenest condos in MI. This condo, situated on Muskegon Lake, will have amazing sunset views. This gorgeous 2 bedroom (3rd bedroom upgrade available) and 2 bath 1,484 sq ft condo boasts an open floor plan with kitchen island, [...]

- 3 beds
- 2 baths
- Condominium
- Residential
- Active
- 1484 sq ft

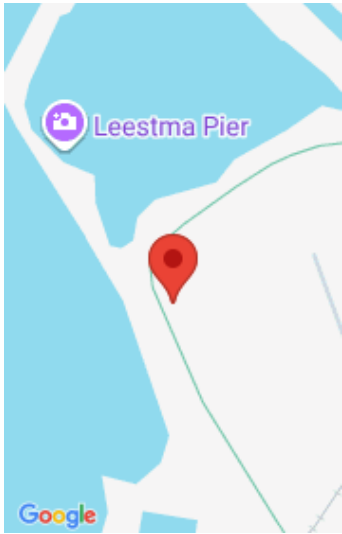

Call us now

Phone: (231)730-8781  
Email: tuckerbennerteam@gmail.com  
Address: 2747 Lakeshore Drive, Twin Lake, MI 49457

# Basics

**Category:** Residential

**Status:** Active

**Bathrooms:** 2 baths

**Lot size:** 0 sq ft

**Bathrooms Full:** 2

**Rooms Total:** 8

**Type:** Condominium

**Bedrooms:** 3 beds

**Area:** 1484 sq ft

**Year built:** 2023

**Lot Size Acres:** 0 acres

**County:** Muskegon

# Building Details

**Construction Materials:** Other

**Sewer:** Public Sewer

**Stories:** 1

**Architectural Style:** Other

**Heating:** Forced Air, Natural Gas

**Basement:** Other

# Amenities & Features

**Pool Features:** Outdoor/Inground

**Parking Features:** Attached

**Garage Spaces:** 1

**Interior Features:** Elevator, Kitchen Island

**Association Amenities:** Pets Allowed, Fitness Center, Meeting Room, Pool

**Waterfront Features:** All Sports, Dock, Shared Frontage

**WaterSource:** Public

**Cooling:** Central Air

# Fees & Taxes

**Association Fee Frequency:** Monthly

**Association Fee:** \$298

**Association Fee Includes:** Snow Removal, Lawn/Yard Care

## Call us now



---

# School Information

**High School District:** Muskegon

---

# Miscellaneous

**CrossStreet:** W Western & Adelaide Circle

**Listing Terms:** Cash, Conventional

**Call us now**