

901, ADELAIDE, MUSKEGON, MI, 49441

https://tuckerbenner.com

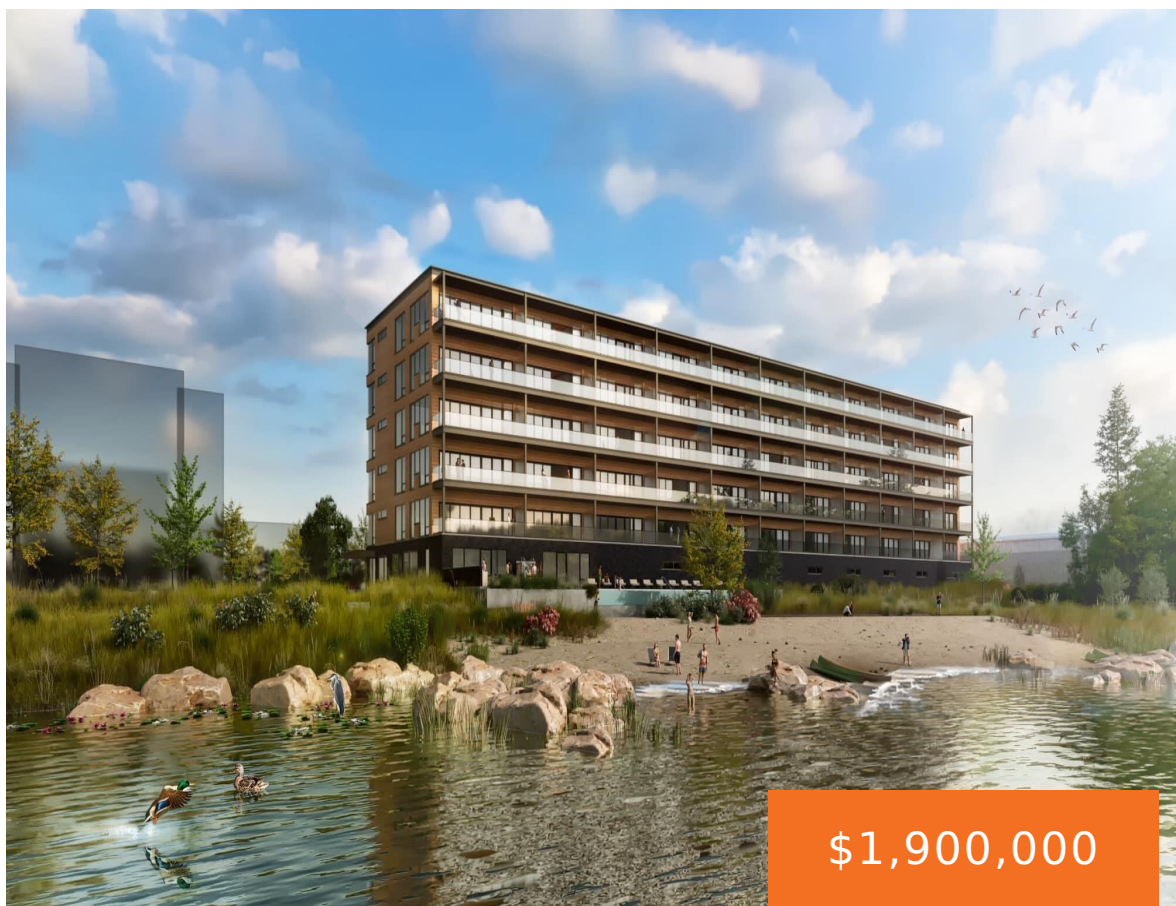

Welcome to Adelaide Pointe where you'll find the best of everything! Michigan's first Mass Timber Condos and greenest condos in MI. This condo, situated on Muskegon Lake, will have amazing sunset views. This gorgeous 3 bedroom (4th bedroom upgrade available) and 2.5 bath 1,726 sq ft condo boasts an open floor plan with kitchen island, [...]

- 4 beds
- 3 baths
- Condominium
- Residential
- Active
- 1726 sq ft

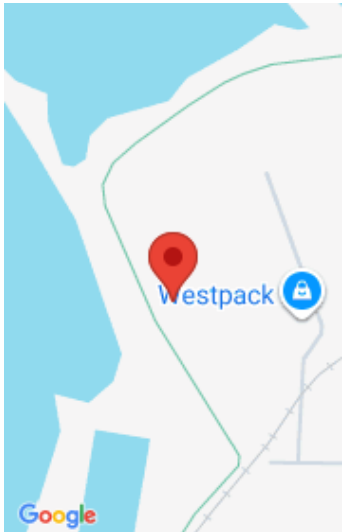

Call us now

Phone: (231)730-8781  
Email: tuckerbennerteam@gmail.com  
Address: 2747 Lakeshore Drive, Twin Lake, MI 49457

# Basics

**Category:** Residential

**Status:** Active

**Bathrooms:** 3 baths

**Lot size:** 0 sq ft

**Bathrooms Full:** 2

**Rooms Total:** 10

**Bathrooms Half:** 1

**Type:** Condominium

**Bedrooms:** 4 beds

**Area:** 1726 sq ft

**Year built:** 2023

**Lot Size Acres:** 0 acres

**County:** Muskegon

# Building Details

**Building Area Total:** 1726 sq ft

**Architectural Style:** Other

**Heating:** Forced Air, Natural Gas

**Basement:** Other

**Construction Materials:** Other

**Sewer:** Public Sewer

**Stories:** 1

# Amenities & Features

**Pool Features:** Outdoor/Inground

**Parking Features:** Attached

**Garage Spaces:** 1

**Interior Features:** Elevator, Kitchen Island

**Association Amenities:** Pets Allowed, Fitness Center, Meeting Room, Pool

**Waterfront Features:** All Sports, Dock, Shared Frontage

**WaterSource:** Public

**Cooling:** Central Air

# Fees & Taxes

**Association Fee Frequency:** Monthly

**Association Fee:** \$298

**Association Fee Includes:** Snow Removal, Lawn/Yard Care

Call us now

---

# School Information

**High School District:** Muskegon

---

# Miscellaneous

**CrossStreet:** W Western & Adelaide Circle

**Listing Terms:** Cash, Conventional

**Call us now**