

901, ADELAIDE, MUSKEGON, MI, 49441

<https://tuckerbenner.com>

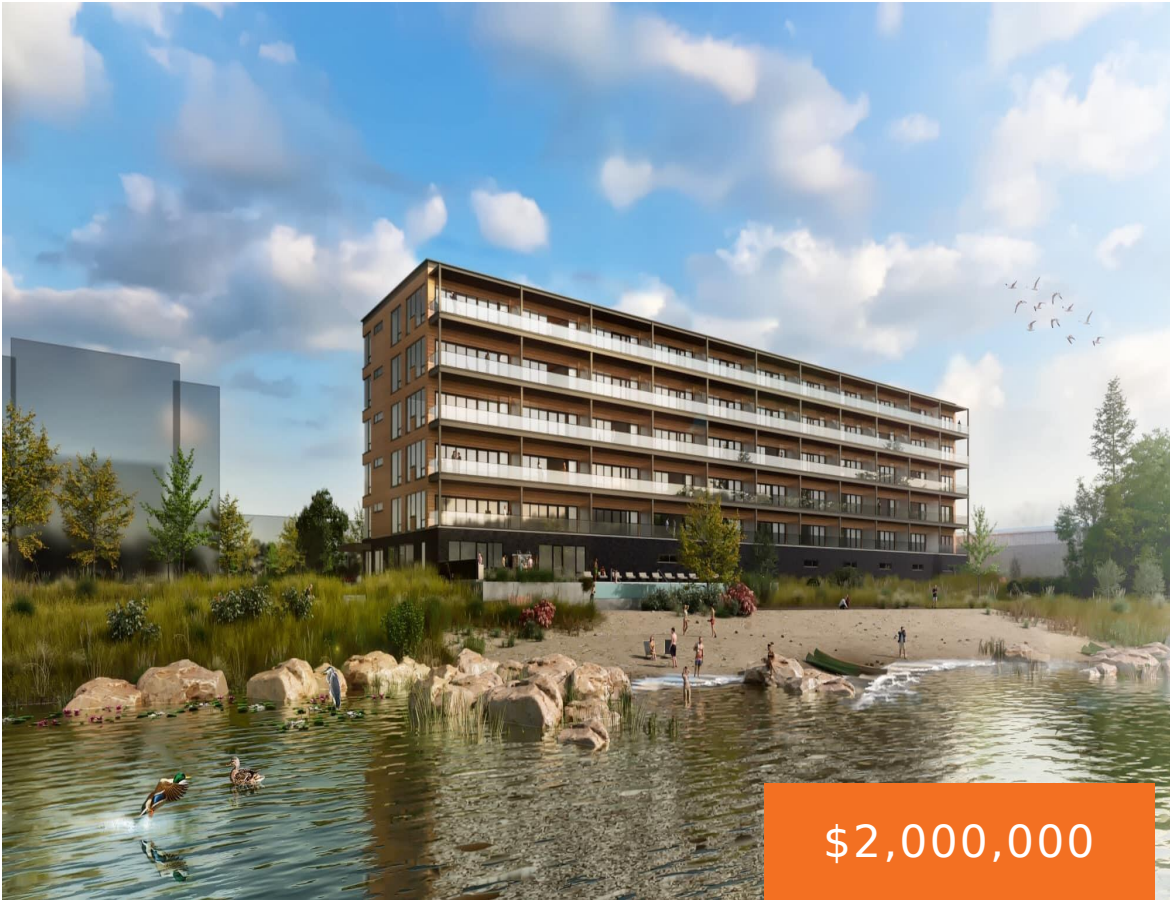

Welcome to Adelaide Pointe where you'll find the best of everything! Michigan's first Mass Timber Condos and greenest condos in MI. This condo, situated on Muskegon Lake, will have amazing sunset views. This gorgeous 3 bedroom (4th bedroom upgrade available) and 2 bath 1,726 sq foot condo boasts an open floor plan with kitchen island, [...]

- 4 beds
- 3 baths
- Condominium
- Residential
- Active
- 1726 sq ft



Basics



Call us now

Phone: (231)730-8781
 Email: tuckerbennerteam@gmail.com
 Address: 2747 Lakeshore Drive, Twin Lake, MI 49457



Category: Residential

Status: Active

Bathrooms: 3 baths

Lot size: 0 sq ft

Bathrooms Full: 2

Rooms Total: 10

Bathrooms Half: 1

Type: Condominium

Bedrooms: 4 beds

Area: 1726 sq ft

Year built: 2023

Lot Size Acres: 0 acres

County: Muskegon

Building Details

Building Area Total: 1726 sq ft

Architectural Style: Other

Heating: Forced Air, Natural Gas

Basement: Other

Construction Materials: Other

Sewer: Public Sewer

Stories: 1

Amenities & Features

Laundry Features: Main Level

Association Amenities: Pets Allowed, Fitness Center, Meeting Room, Pool

Waterfront Features: All Sports, Dock, Shared Frontage

WaterSource: Public

Exterior Features: Deck(s)

Pool Features: Outdoor/Inground

Parking Features: Attached

Garage Spaces: 1

Interior Features: Elevator, Kitchen Island

Cooling: Central Air

Fees & Taxes

Association Fee Frequency: Monthly

Association Fee Includes: Snow Removal, Lawn/Yard Care

Association Fee: \$298



Call us now

Phone: (231)730-8781

Email: tuckerbennerteam@gmail.com

Address: 2747 Lakeshore Drive, Twin Lake, MI 49457



School Information

High School District: Muskegon

Miscellaneous

CrossStreet: W Western & Adelaide Circle

Listing Terms: Cash, Conventional



Call us now

Phone: (231)730-8781

Email: tuckerbennerteam@gmail.com

Address: 2747 Lakeshore Drive, Twin Lake, MI 49457

