

9122, RICHLAND WOODS, RICHLAND, MI, 49083

<https://tuckerbenner.com>

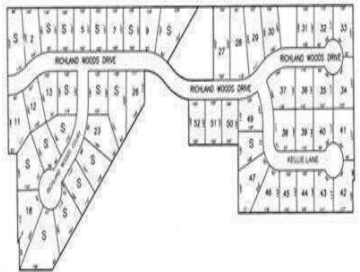

Don't miss the opportunity to own this deep lot located in the heart of the Village of Richland, within the highly sought after Gull Lake School district. Enjoy the convenience of being within walking distance to local restaurants, grocery stores and other village amenities. This is the perfect location to build your dream home and [...]

- 0 baths
- Acreage
- Land
- Active

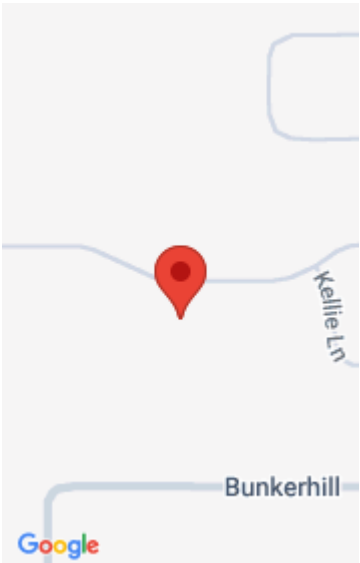

Basics

Category: Land

Status: Active

Lot size: 0.35 sq ft

County: Kalamazoo

Type: Acreage

Bathrooms: 0 baths

Lot Size Acres: 0.35 acres

Amenities & Features

Utilities: Water Available, Sewer Available, None

Lot Features: Buildable, Wooded

Fees & Taxes

Tax Assessed Value: \$22,700

Tax Year: 2024

Tax Annual Amount: \$286

School Information

High School District: Gull Lake

Miscellaneous

Road Surface Type: Paved

CrossStreet: M-89 & East DE Ave

Listing Terms: Cash, Conventional

Call us now