

9131, 42ND, HICKORY CORNERS, MI, 49060
https://tuckerbenner.com

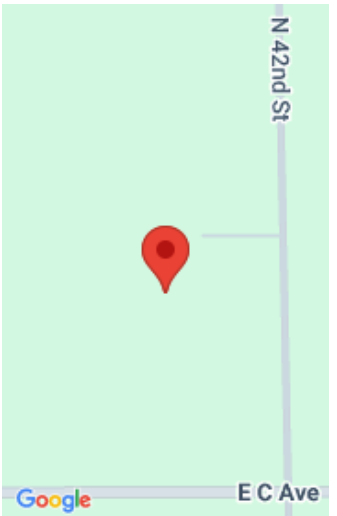

This spacious 3 bedroom, 2.5 bath one-owner custom home on 6 acres. Directly across the street are several hundred acres of state owned land with the Augusta Creek flowing through. Featuring an open floor plan with spacious rooms, two bedrooms with their own ensuite bathrooms, and bright, light-filled living areas. The eat - in kitchen features [...]

- 3 beds
- 3 baths
- Single Family Residence
- Residential
- Active
- 3668 sq ft



Call us now

Phone: (231)730-8781
Email: tuckerbennerteam@gmail.com
Address: 2747 Lakeshore Drive, Twin Lake, MI 49457

Basics

Category: Residential

Status: Active

Bathrooms: 3 baths

Lot size: 6 sq ft

Bathrooms Full: 2

Rooms Total: 5

Bathrooms Half: 1

Type: Single Family Residence

Bedrooms: 3 beds

Area: 3668 sq ft

Year built: 2000

Lot Size Acres: 6 acres

County: Kalamazoo

Building Details

Building Area Total: 2568 sq ft

Architectural Style: Ranch

Heating: Forced Air

Roof: Composition, Shingle

Construction Materials: Vinyl Siding

Sewer: Septic Tank

Stories: 1

Basement: Full

Amenities & Features

Laundry Features: Main Level

Parking Features: Attached

WaterSource: Well

Interior Features: Eat-in Kitchen

Fireplaces Total: 1

Flooring: Wood

Garage Spaces: 2

Appliances: Dishwasher, Microwave, Range, Refrigerator

Lot Features: Wooded

Cooling: Central Air

Fees & Taxes

Tax Assessed Value: \$165,809

Tax Year: 2025

Call us now

School Information

High School District: Gull Lake

Miscellaneous

CrossStreet: E CD Ave & N 42nd St

Listing Terms: Cash, Conventional

Call us now



Phone: (231)730-8781
Email: tuckerbennerteam@gmail.com
Address: 2747 Lakeshore Drive, Twin Lake, MI 49457

