

9194, KELLIE, RICHLAND, MI, 49083

https://tuckerbenner.com

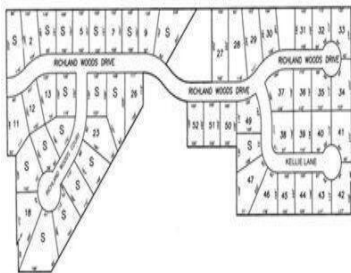

Cul-De-Sac lot in the Village of Richland and Gull Lake Schools. Easy walking distance to the Village Center and Gull Lake Schools. All lots have public water and sewer and underground utilities (gas, electric, cable, and phone). Cornerstone Construction & Builders LLC. is the exclusive builder on this lot.

- 0 baths
- Lot
- Land
- Active



Basics

**Category:** Land  
**Status:** Active  
**Lot size:** 0.47 sq ft  
**County:** Kalamazoo

**Type:** Lot  
**Bathrooms:** 0 baths  
**Lot Size Acres:** 0.47 acres

Call us now

Phone: (231)730-8781  
Email: tuckerbennerteam@gmail.com  
Address: 2747 Lakeshore Drive, Twin Lake, MI 49457



---

## Fees & Taxes

**Tax Assessed Value:** \$969

**Tax Year:** 2021

**Tax Annual Amount:** \$59

---

## School Information

**High School District:** Gull Lake

---

## Miscellaneous

**CrossStreet:** M89 & East DE Ave

**Listing Terms:** Cash, Conventional

**Call us now**



Phone: (231)730-8781

Email: tuckerbennerteam@gmail.com

Address: 2747 Lakeshore Drive, Twin Lake, MI 49457

