

9282, 100TH ST, BYRON CENTER, MI, 49315

https://tuckerbenner.com

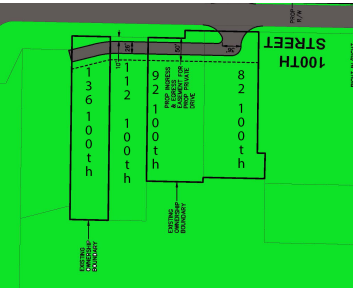
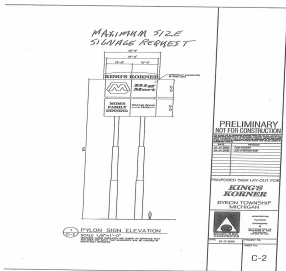
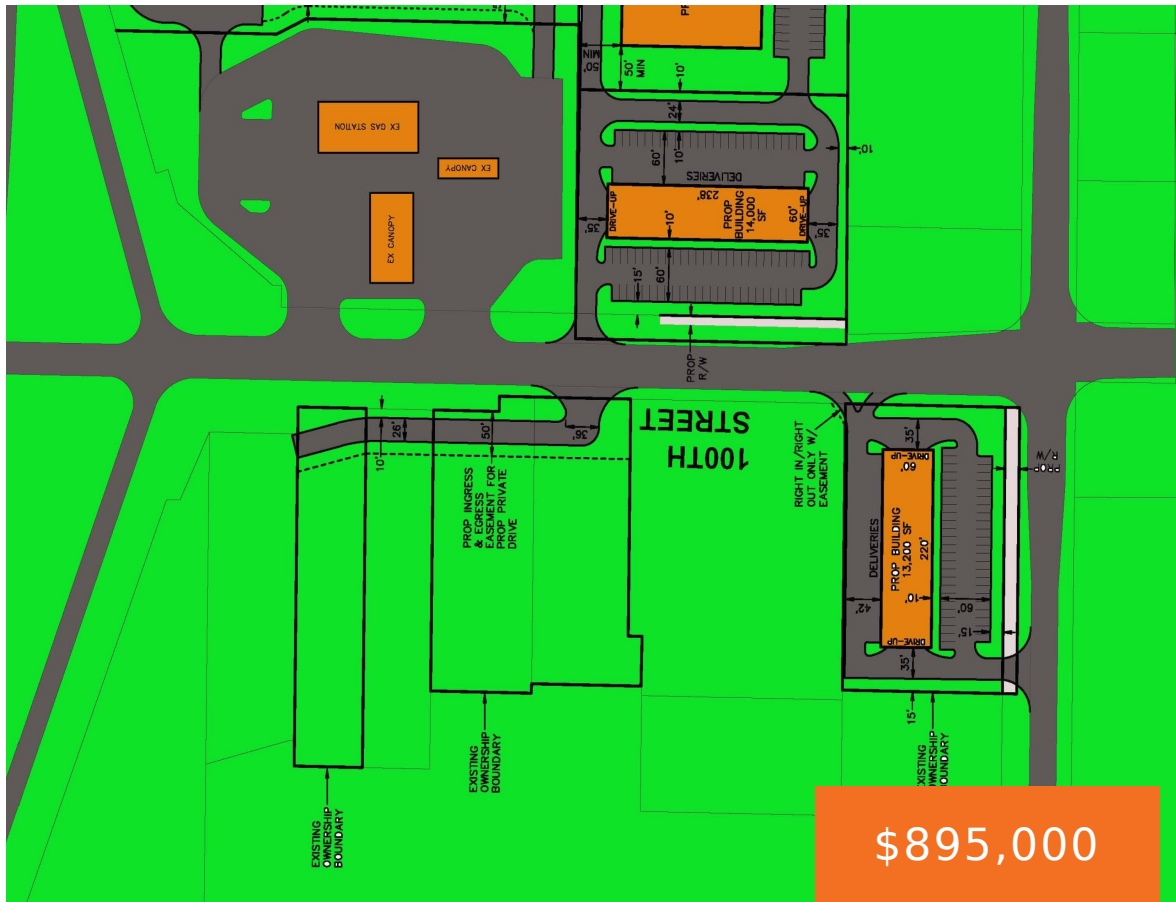

Buyer must develop in a manner to extend road access, Ingress/Egress, the utilities through to serve 136 and 112 100th st.

- 0 baths
- Acreage
- Land
- Active



---

# Basics

**Category:** Land

**Status:** Active

**Lot size:** 1.76 sq ft

**County:** Kent

**Type:** Acreage

**Bathrooms:** 0 baths

**Lot Size Acres:** 1.76 acres

---

# Amenities & Features

**Utilities:** Septic Connected, None Available

---

# Fees & Taxes

**Tax Assessed Value:** \$152,860

**Tax Annual Amount:** \$11,220

**Tax Year:** 2024

---

# School Information

**High School District:** Byron Center

---

# Miscellaneous

**CrossStreet:** Division and 100th st

**Listing Terms:** Cash, Conventional

Call us now