

9483, BLUFF RIDGE, ZEELAND, MI, 49464

https://tuckerbenner.com

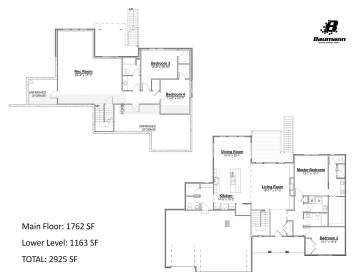

This new Hamlin floor plan is currently being built by Baumann Building in the Bluff Lake Community in Zeeland! This wonderful home features 4 bedrooms and 3.5 bathrooms. The owners suite offers a tile shower and a spacious walk-in closet. The laundry room with a sink is on the main floor. The open concept kitchen [...]

- 4 beds
- 4 baths
- Single Family Residence
- Residential
- Active
- 2925 sq ft

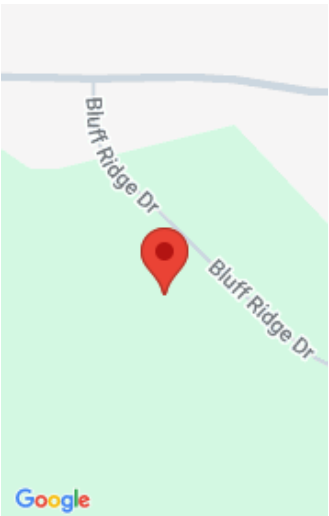

Call us now

Phone: (231)730-8781
Email: tuckerbennerteam@gmail.com
Address: 2747 Lakeshore Drive, Twin Lake, MI 49457

Basics

Category: Residential
Status: Active
Bathrooms: 4 baths
Lot size: 0.6 sq ft
Bathrooms Full: 3
Rooms Total: 4
Bathrooms Half: 1

Type: Single Family Residence
Bedrooms: 4 beds
Area: 2925 sq ft
Year built: 2025
Lot Size Acres: 0.6 acres
County: Ottawa

Building Details

Building Area Total: 1762 sq ft
Architectural Style: Ranch
Heating: Forced Air
Roof: Shingle

Construction Materials: Vinyl Siding
Sewer: Public
Stories: 1
Basement: Walk-Out Access

Amenities & Features

Laundry Features: Laundry Room, Main Level, Sink
Fireplace Features: Gas Log
WaterSource: Public
Interior Features: Center Island, Pantry
Fireplaces Total: 1

Parking Features: Attached
Garage Spaces: 3
Appliances: Dishwasher, Microwave, Range, Refrigerator
Patio And Porch Features: Deck, Porch(es)
Cooling: Central Air

Fees & Taxes

Call us now

Tax Assessed Value: \$3,478

Association Fee: \$8

Association Fee Includes: None

Association Fee Frequency: Monthly

Tax Year: 2025

School Information

High School District: Zeeland

Miscellaneous

CrossStreet: 96th & Bluff Lake St

Listing Terms: Cash, FHA, VA Loan, Conventional

Call us now