

# 961, BOARDWALK COVE, MUSKEGON, MI, 49441

<https://tuckerbenner.com>

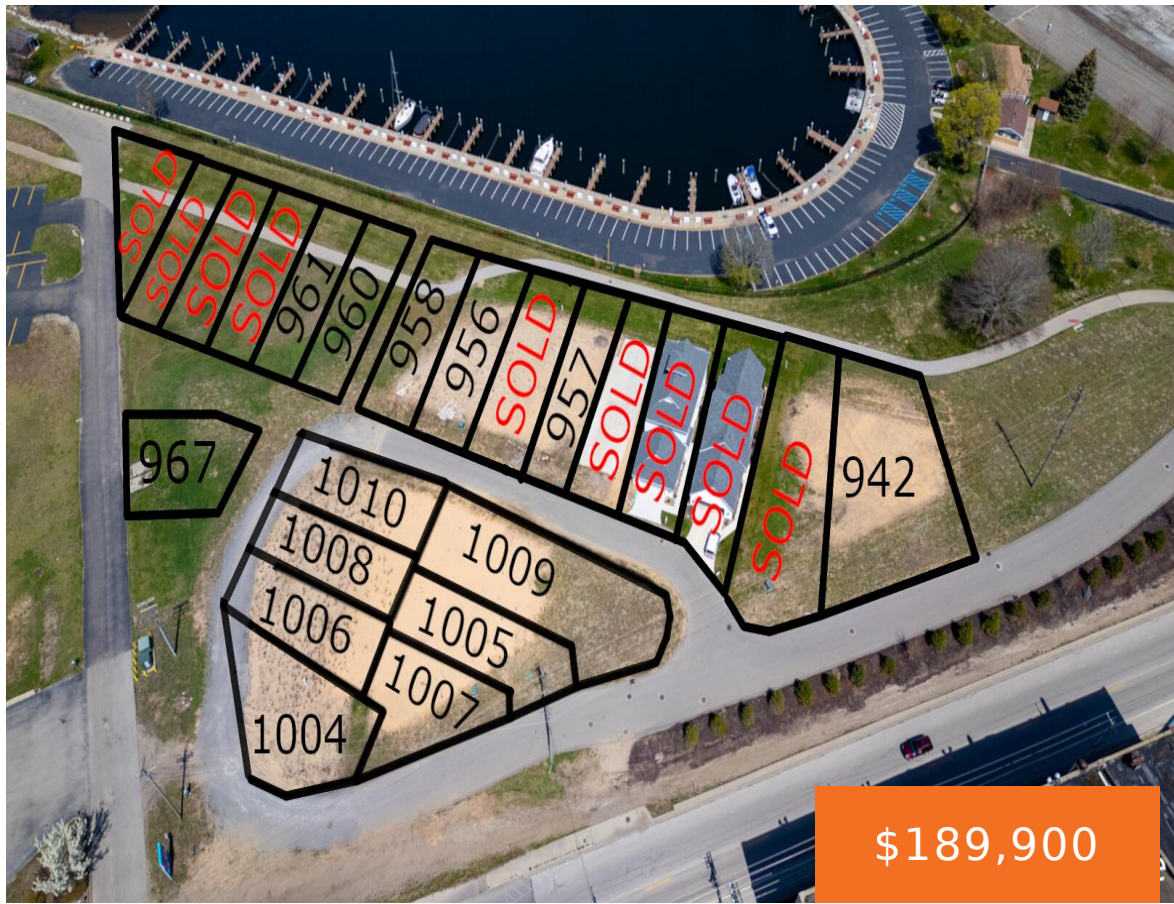

Discover the perfect canvas for your vision with this waterfront buildable lot. Ideal for builders and developers seeking an exceptional investment opportunity or a buyer looking to build their dream home in a great location. This parcel promises endless possibilities in a highly sought-after location. With breathtaking water views and proximity to Heritage Landing and [...]

- 0 baths
- Acreage
- Land
- Active



## Basics

**Category:** Land

**Status:** Active

**Lot size:** 0.05 sq ft

**County:** Muskegon

**Type:** Acreage

**Bathrooms:** 0 baths

**Lot Size Acres:** 0.05 acres

## Call us now



Phone: (231)730-8781

Email: [tuckerbennerteam@gmail.com](mailto:tuckerbennerteam@gmail.com)

Address: 2747 Lakeshore Drive, Twin Lake, MI 49457



---

## Building Details

**Sewer:** Public Sewer

---

## Amenities & Features

**Utilities:** Cable Available, Natural Gas Connected, Phone Available, Electricity Connected

**WaterSource:** Public

**Waterfront Features:** Lake

**Lot Features:** Level, Buildable, Cleared, Cul-De-Sac, Sidewalk

---

## Fees & Taxes

**Tax Assessed Value:** \$13,531

**Tax Year:** 2024

**Tax Annual Amount:** \$786

---

## School Information

**High School District:** Muskegon

---

## Miscellaneous

**Road Surface Type:** Paved

**CrossStreet:** Western & Division

**Listing Terms:** Cash, Conventional

### Call us now



Phone: (231)730-8781

Email: tuckerbennerteam@gmail.com

Address: 2747 Lakeshore Drive, Twin Lake, MI 49457

