

# 9631, ANNA MARIA, PORTAGE, MI, 49002

<https://tuckerbenner.com>

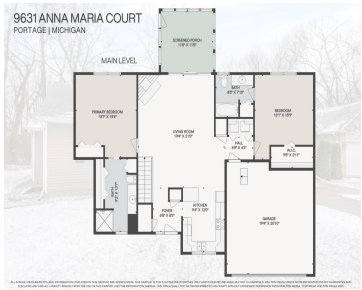

**\$292,500**

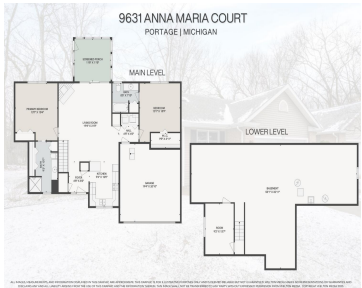

Here is your opportunity to experience condominium living in South Portage. Sterling Oaks is a wonderful community featuring spacious stand-alone condos. Tired of mowing the lawn and shoveling the snow? Then this condo is for you. This well-maintained, one-owner, 2-bedroom, 2 full and 1 half-bath condo offers over 1,325 finished square feet of living space. [...]

- 2 beds
- 3 baths
- Condominium
- Residential
- Active
- 1432 sq ft



## Basics



### Call us now

Phone: (231)730-8781  
Email: [tuckerbennerteam@gmail.com](mailto:tuckerbennerteam@gmail.com)  
Address: 2747 Lakeshore Drive, Twin Lake, MI 49457



**Category:** Residential

**Status:** Active

**Bathrooms:** 3 baths

**Lot size:** 0 sq ft

**Subdivision Name:** Sterling Oaks

**Lot Size Acres:** 0 acres

**County:** Kalamazoo

**Type:** Condominium

**Bedrooms:** 2 beds

**Area:** 1432 sq ft

**Year built:** 2000

**Bathrooms Full:** 2

**Rooms Total:** 6

**Bathrooms Half:** 1

---

## Building Details

**Building Area Total:** 1324 sq ft

**Architectural Style:** Ranch

**Heating:** Forced Air

**Roof:** Composition

**Construction Materials:** Brick, Vinyl Siding

**Sewer:** Public Sewer

**Stories:** 1

**Basement:** Full

---

## Amenities & Features

**Laundry Features:** In Hall, Main Level

**Association Amenities:** Pets Allowed

**Fireplace Features:** Gas Log, Living Room

**WaterSource:** Public

**Interior Features:** Ceiling Fan(s), Garage Door Opener, Iron Water Filter, Laminate Floor, Water Softener/Owned, Eat-in Kitchen, Pantry

**Window Features:** Skylight(s), Screens, Replacement, Insulated Windows, Window Treatments

**Fireplaces Total:** 1

**Utilities:** Natural Gas Available, Cable Available, Natural Gas Connected, Cable Connected, Storm Sewer, Public Water, Public Sewer, High-Speed Internet

**Parking Features:** Garage Faces Front, Garage Door Opener, Attached

**Garage Spaces:** 2

**Appliances:** Washer, Refrigerator, Range, Oven, Microwave, Dryer, Disposal, Dishwasher

**Lot Features:** Wooded, Cul-De-Sac

**Exterior Features:** Patio, 3 Season Room

**Cooling:** Central Air



### Call us now

Phone: (231)730-8781

Email: [tuckerbennerteam@gmail.com](mailto:tuckerbennerteam@gmail.com)

Address: 2747 Lakeshore Drive, Twin Lake, MI 49457



---

## Fees & Taxes

**Tax Assessed Value:** \$97,032    **Association Fee Frequency:** Monthly

**Association Fee:** \$275    **Tax Year:** 2024

**Tax Annual Amount:** \$4,404    **Association Fee Includes:** Trash, Snow Removal, Lawn/Yard Care

---

## School Information

**High School District:** Portage

**HighSchool:** Portage Central High School

**Middle Or Junior School:** Central Middle School

**Elementary School:** Lake Center Elementary School

---

## Miscellaneous

**Road Surface Type:** Paved

**CrossStreet:** Marco Drive and end

**Listing Terms:** Cash, Conventional



### Call us now

Phone: (231)730-8781

Email: tuckerbennerteam@gmail.com

Address: 2747 Lakeshore Drive, Twin Lake, MI 49457

