

9673, 27TH, RICHLAND, MI, 49083

https://tuckerbenner.com



\$629,827



THIS is the one you have been waiting for! Great curb appeal, 2.6 acres with trails, convenient location, open and spacious floor plan and 2204 square feet of Awesome! You will love pulling into the driveway and calling this sunny modern farmhouse your home. As you enter the front door you will notice 14 feet [...]

- 3 beds
- 3 baths
- Single Family Residence
- Residential
- Active
- 2204 sq ft

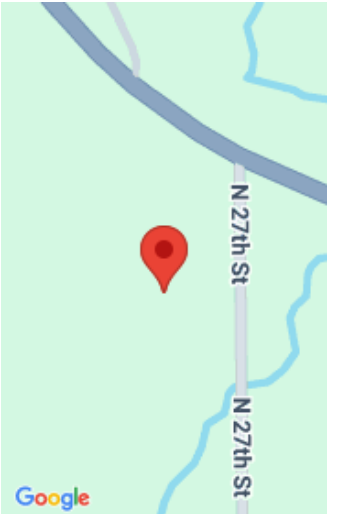

Call us now

Phone: (231)730-8781
Email: tuckerbennerteam@gmail.com
Address: 2747 Lakeshore Drive, Twin Lake, MI 49457

Basics

Category: Residential

Status: Active

Bathrooms: 3 baths

Lot size: 2.6 sq ft

Bathrooms Full: 2

Rooms Total: 5

Bathrooms Half: 1

Type: Single Family Residence

Bedrooms: 3 beds

Area: 2204 sq ft

Year built: 2024

Lot Size Acres: 2.6 acres

County: Kalamazoo

Building Details

Building Area Total: 2204 sq ft

Architectural Style: Barndominium

Heating: Forced Air

Roof: Metal

Construction Materials: Vinyl Siding

Sewer: Septic Tank

Stories: 1

Basement: Slab

Amenities & Features

Laundry Features: Laundry Room, Main Level

Parking Features: Attached

Garage Spaces: 2

Appliances: Dishwasher, Range, Refrigerator

Lot Features: Level, Wooded

Patio And Porch Features: Patio, Porch(es)

Fireplaces Total: 1

Utilities: Natural Gas Connected

Fireplace Features: Living Room

WaterSource: Well

Interior Features: Center Island, Pantry

Window Features: Insulated Windows

Exterior Features: Other

Cooling: Central Air

Fees & Taxes

Call us now

Tax Assessed Value: \$236,500
Tax Annual Amount: \$1,874

Tax Year: 2025

School Information

High School District: Gull Lake

Miscellaneous

Road Surface Type: Paved

CrossStreet: M-89 and C Avenue

Listing Terms: Cash, FHA, VA Loan, Conventional

Call us now



Phone: (231)730-8781
Email: tuckerbennerteam@gmail.com
Address: 2747 Lakeshore Drive, Twin Lake, MI 49457

