

98, CHASE, KENT CITY, MI, 49330

https://tuckerbenner.com

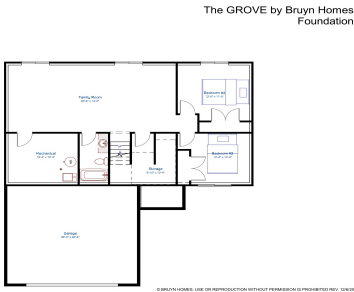
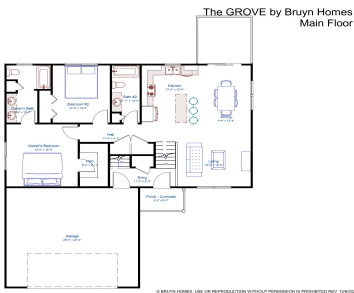

Welcome to 98 Chase Ct NW, a stunning new bi-level home built by Bruyn Homes, offering over 1,500 finished sq ft of modern living space. The open-concept design features large windows that flood the living room, dining area, and kitchen with natural light. The kitchen is a showstopper with quartz countertops, a subway tile backsplash, [...]

- 2 beds
- 2 baths
- Single Family Residence
- Residential
- Active
- 1586 sq ft

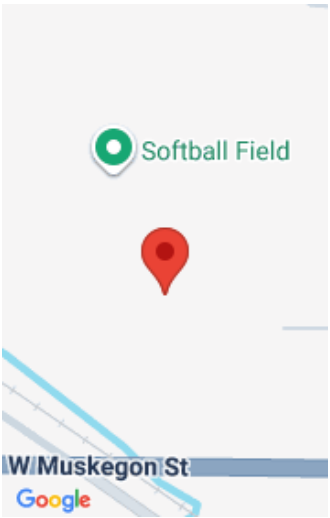

Call us now

Phone: (231)730-8781
Email: tuckerbennerteam@gmail.com
Address: 2747 Lakeshore Drive, Twin Lake, MI 49457

Basics

Category: Residential	Type: Single Family Residence
Status: Active	Bedrooms: 2 beds
Bathrooms: 2 baths	Area: 1586 sq ft
Lot size: 0.24 sq ft	Year built: 2025
Subdivision Name: Chase Orchards	Bathrooms Full: 2
Lot Size Acres: 0.24 acres	Rooms Total: 5
County: Kent	

Building Details

Building Area Total: 1136 sq ft	Construction Materials: Aluminum Siding, Vinyl Siding
Sewer: Public	Heating: Forced Air
Stories: 2	Roof: Shingle
Levels: Tri-Level	Basement: Daylight, Full

Amenities & Features

Laundry Features: Gas Dryer Hookup, Lower Level, Washer Hookup	Flooring: Carpet, Laminate
Utilities: Natural Gas Connected, Storm Sewer	Parking Features: Garage Faces Front, Attached
Garage Spaces: 2	WaterSource: Well
Appliances: Dishwasher, Microwave, Range, Refrigerator	Interior Features: Center Island, Eat-in Kitchen
Lot Features: Flag Lot	Window Features: Low-Emissivity Windows
Patio And Porch Features: Deck	Cooling: SEER 13 or Greater

Fees & Taxes

Call us now

Tax Year: 2024

School Information

High School District: Kent City

Miscellaneous

Road Surface Type: Paved

CrossStreet: Clover & West Muskegon

Listing Terms: Cash, FHA, VA Loan, Conventional

Call us now



Phone: (231)730-8781
Email: tuckerbennerteam@gmail.com
Address: 2747 Lakeshore Drive, Twin Lake, MI 49457

