

AMBS, JACKSON, MI, 49201

<https://tuckerbenner.com>

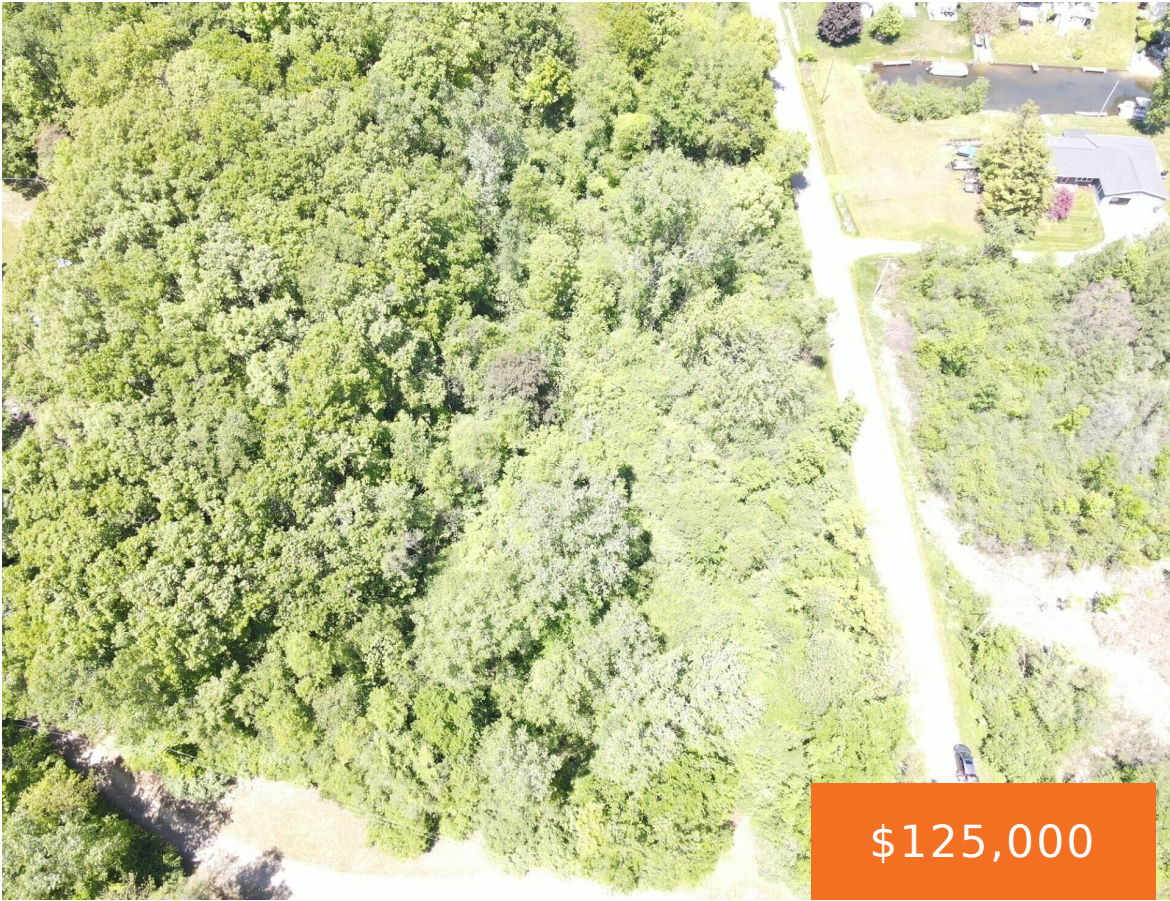

\$125,000



Rare opportunity to own 3.1 acres with an included separate lakefront parcel! The main parcel offers plenty of space and potential, making it ideal for developers, builders, investors, or anyone seeking property near the water. The additional lakefront parcel provides direct lake access and the enjoyment of waterfront living, adding unique recreational and scenic value [...]

- 0 baths
- Acreage
- Land
- Active



Basics

Category: Land

Status: Active

Lot size: 3.14 sq ft

County: Jackson

Type: Acreage

Bathrooms: 0 baths

Lot Size Acres: 3.14 acres

Call us now



Phone: (231)730-8781

Email: tuckerbennerteam@gmail.com

Address: 2747 Lakeshore Drive, Twin Lake, MI 49457



Amenities & Features

Utilities: Electricity Available, None

Waterfront Features: Lake

Fees & Taxes

Tax Assessed Value: \$1,690

Tax Year: 2025

Tax Annual Amount: \$150

School Information

High School District: Michigan Center

Miscellaneous

Road Surface Type: Paved

CrossStreet: AMBS & SHADY LANE

Listing Terms: Cash, Conventional

Call us now



Phone: (231)730-8781

Email: tuckerbennerteam@gmail.com

Address: 2747 Lakeshore Drive, Twin Lake, MI 49457

