

# ASHLYN, FOWLERVILLE, MI, 48836

<https://tuckerbenner.com>

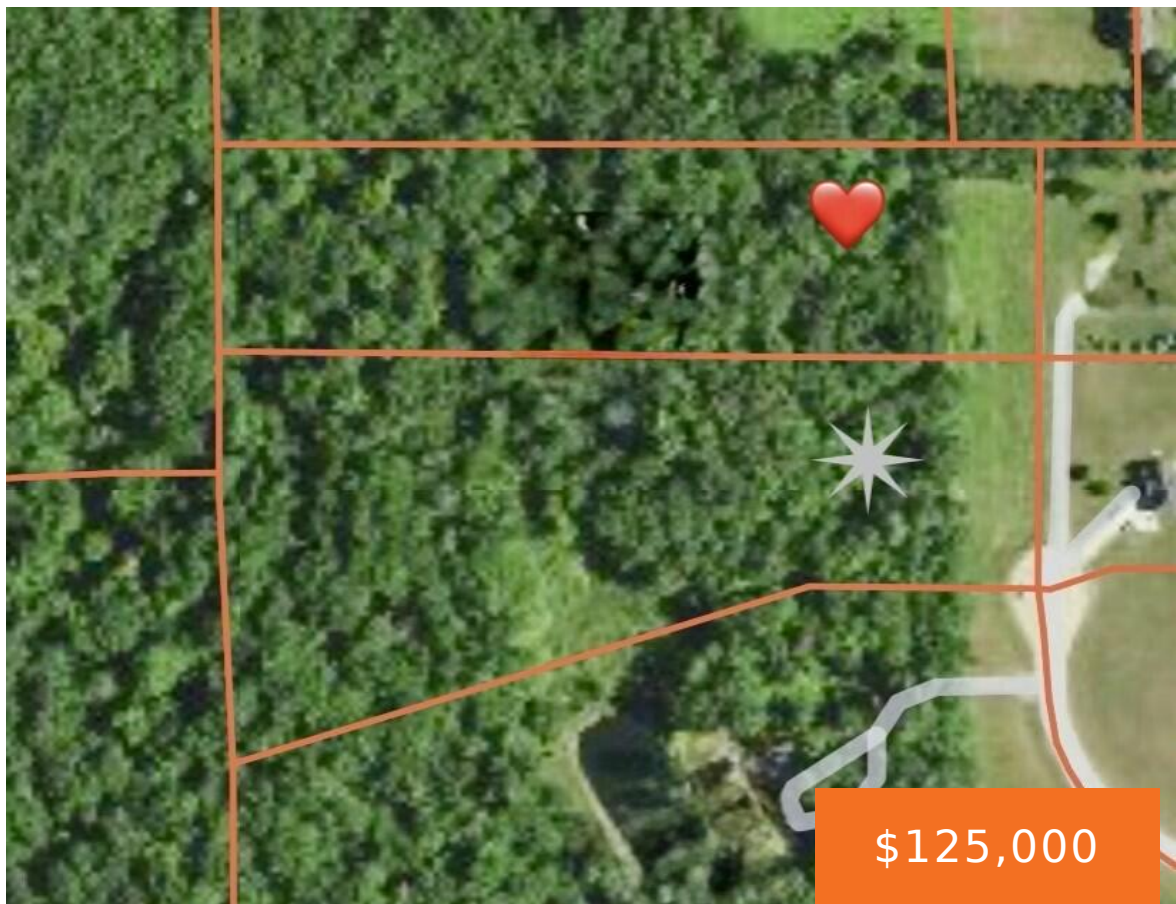

This parcel is adjacent to the home also listed for sale (see MLS#26004874) and provides a great investment opportunity while living next door! The long, winding, private road of Ashlyn Dr. leads you back to 6.75 acres offering gently rolling hills, trails, woods and a myriad of wildlife! The perc test has been completed for [...]

- 0 baths
- Acreage
- Land
- Active



# Basics

**Category:** Land

**Status:** Active

**Lot size:** 6.75 sq ft

**County:** Livingston

**Type:** Acreage

**Bathrooms:** 0 baths

**Lot Size Acres:** 6.75 acres

# Building Details

**Current Use:** Residential

# Amenities & Features

**Utilities:** Electricity Available, Cable Available, Electricity Connected

**Lot Features:** Rolling Hills, Buildable, Cul-De-Sac, Wooded

# Fees & Taxes

**Tax Assessed Value:** \$21,937

**Tax Annual Amount:** \$1,007.42

**Tax Year:** 2025

# School Information

**High School District:** Fowlerville

# Miscellaneous

**CrossStreet:** Odell and Ashlyn Ct

**Listing Terms:** Cash, Conventional

Call us now