

CORA AVE, FARMINGTON HILLS, MI, 48336

https://tuckerbenner.com

Tax parcels-Farmington Hills



6/10/2024, 12:37:14 PM

Green outline: Tax parcels

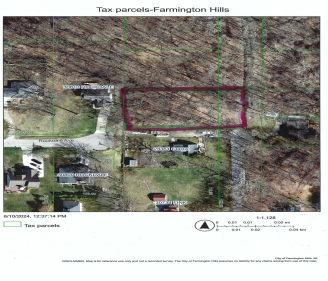
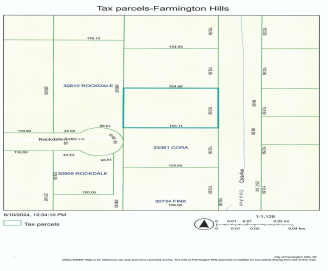
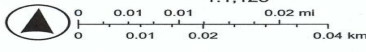

\$48,000

City of Farmington Hills, MI
Reference use only and not a recorded survey. The City of Farmington Hills assumes no liability for any claims arising from use of this map.

- 0 baths
- Lot
- Land
- Active



Basics

Category: Land
Status: Active
Lot size: 0.44 sq ft
Lot Size Acres: 0.44 acres

Type: Lot
Bathrooms: 0 baths
Subdivision Name: Hollywood-Farmington Hills
County: Oakland



Call us now

Phone: (231)730-8781
 Email: tuckerbennerteam@gmail.com
 Address: 2747 Lakeshore Drive, Twin Lake, MI 49457



Amenities & Features

Utilities: None Connected, Public Sewer Available, Electric Available

Lot Features: Level, Buildable

Fees & Taxes

Tax Assessed Value: \$3,290

Tax Year: 3290

Tax Annual Amount: \$183

School Information

High School District: Farmington

Miscellaneous

CrossStreet: Orchard Lake and Shiawassee

Listing Terms: Cash, Rural Development



Call us now

Phone: (231)730-8781

Email: tuckerbennerteam@gmail.com

Address: 2747 Lakeshore Drive, Twin Lake, MI 49457

