

1, STRATFORD, NILES, MI, 49120

<https://tuckerbenner.com>

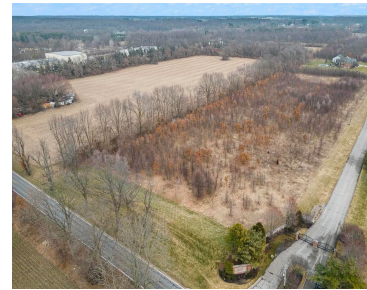
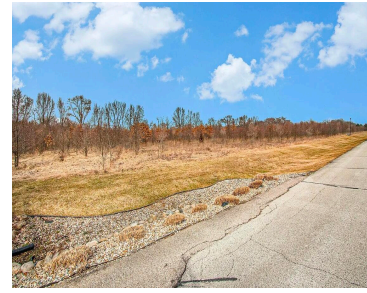

5 acre lot in a gated subdivision in Edwardsburg schools, while still being directly next to Granger! Small, private subdivision that allows you to build exactly what you would like while being conveniently close to everything. Current owner has added over 60 trees along the property line for additional privacy. Do not miss this opportunity!

- 0 baths
- Lot
- Land
- Active



Basics

Category: Land

Status: Active

Lot size: 5.01 sq ft

Lot Size Acres: 5.01 acres

Type: Lot

Bathrooms: 0 baths

Subdivision Name: Stratford Farms

County: Cass



Call us now

Phone: (231)730-8781

Email: tuckerbennerteam@gmail.com

Address: 2747 Lakeshore Drive, Twin Lake, MI 49457



Building Details

Current Use: Residential

Amenities & Features

Utilities: None **Lot Features:** Level, Buildable, Cleared, Cul-De-Sac, Corner Lot

Fees & Taxes

Tax Assessed Value: \$84,000

Association Fee Frequency: Annually

Association Fee: \$1,380

Tax Year: 2024

Tax Annual Amount: \$927

School Information

High School District: Edwardsburg

Miscellaneous

Road Surface Type: Paved

CrossStreet: Fir Rd

Listing Terms: Cash, Conventional



Call us now

Phone: (231)730-8781

Email: tuckerbennerteam@gmail.com

Address: 2747 Lakeshore Drive, Twin Lake, MI 49457

