

1, V/L WILDWOOD, ALGER, MI, 48610

<https://tuckerbenner.com>

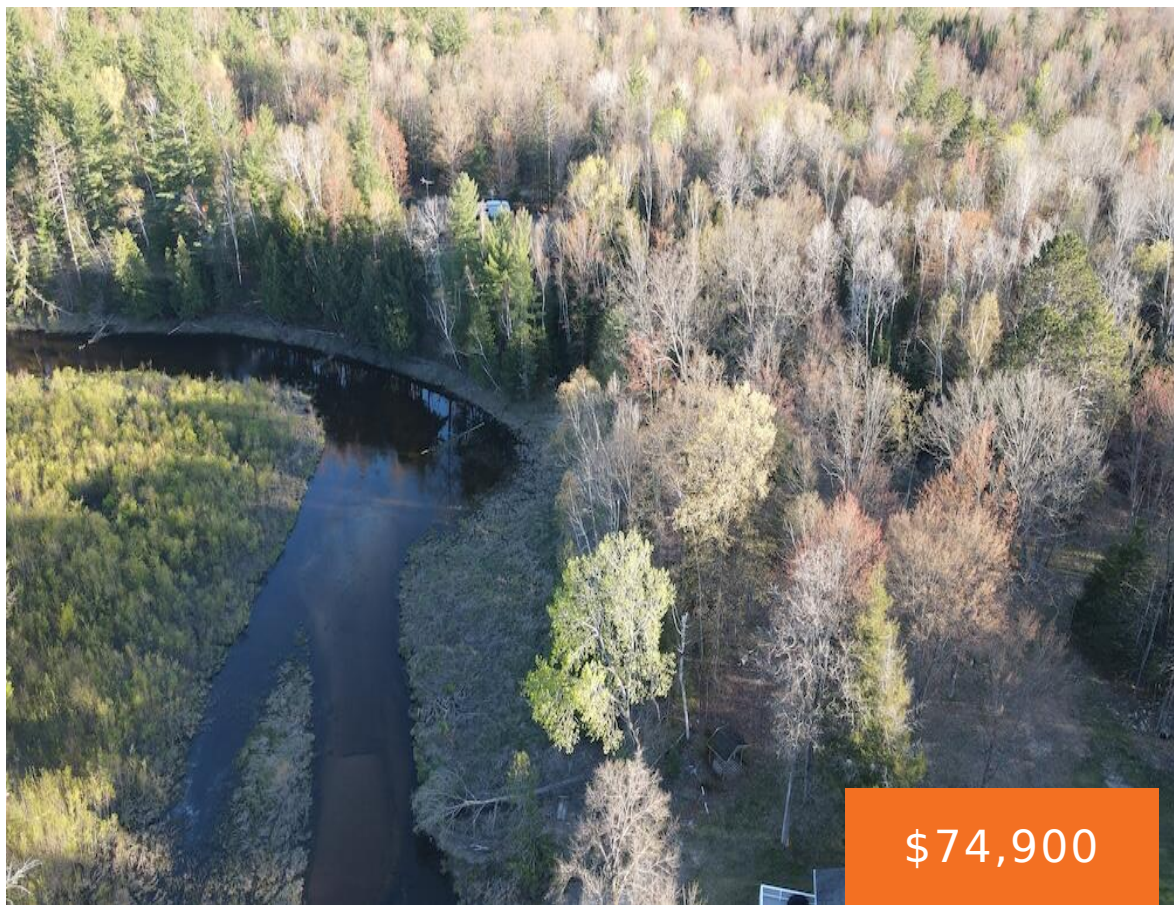

Beautiful 2.5 surveyed-acre Secord Lake waterfront parcel offering an excellent build site with scenic water views and peaceful natural surroundings. This property features mature timber, including maple, oak, and beech, with a picturesque setting ideal for your future home or recreational retreat on Secord Lake. Abundant wildlife makes this a fantastic hunting property, with deer, [...]

- 0 baths
- Acreage
- Land
- Active



Basics

Category: Land

Status: Active

Lot size: 2.5 sq ft

County: Gladwin

Type: Acreage

Bathrooms: 0 baths

Lot Size Acres: 2.5 acres

Call us now



Phone: (231)730-8781

Email: tuckerbennerteam@gmail.com

Address: 2747 Lakeshore Drive, Twin Lake, MI 49457



Amenities & Features

Utilities: Electricity Available, None

Waterfront Features: Lake

School Information

High School District: Gladwin

Miscellaneous

CrossStreet: River Lake Drive

Listing Terms: Cash, Conventional

Call us now



Phone: (231)730-8781

Email: tuckerbennerteam@gmail.com

Address: 2747 Lakeshore Drive, Twin Lake, MI 49457

