

11, RIVER BEND, CONCORD, MI, 49237

<https://tuckerbenner.com>

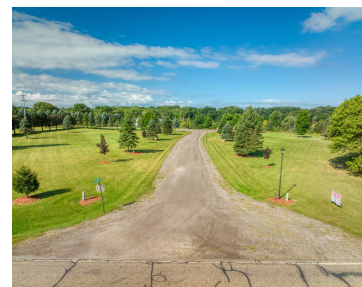

\$36,500



BUILDING LOTS FOR SALE!! Lot #11 of the River Bend Drive subdivision. Build your new high-end home in a new private subdivision. River Bend Drive subdivision is adjacent to the Kalamazoo River, just North of the Village of Concord. All lots have electric & natural gas at the lot front. Call today for your own [...]

- 0 baths
- Lot
- Land
- Active



Basics

Category: Land

Status: Active

Lot size: 0.5 sq ft

Lot Size Acres: 0.5 acres

Type: Lot

Bathrooms: 0 baths

Subdivision Name: RIVER BEND DRIVE

County: Jackson



Call us now

Phone: (231)730-8781

Email: tuckerbennerteam@gmail.com

Address: 2747 Lakeshore Drive, Twin Lake, MI 49457



Building Details

Current Use: Residential

Amenities & Features

Lot Features: Buildable, Cleared, Cul-De-Sac, Site Condo, Wooded

Fees & Taxes

Tax Assessed Value: \$2,056

Association Fee Frequency: Annually

Association Fee: \$75

Tax Year: 2022

Tax Annual Amount: \$136.84

School Information

High School District: Concord

Miscellaneous

Road Surface Type: Unimproved

CrossStreet: Warner Rd.

Listing Terms: Cash, Conventional



Call us now

Phone: (231)730-8781

Email: tuckerbennerteam@gmail.com

Address: 2747 Lakeshore Drive, Twin Lake, MI 49457

