

15, PEPPERMINT, HOLLAND, MI, 49423

https://tuckerbenner.com

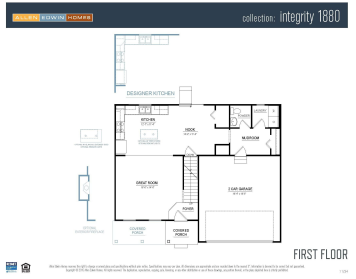
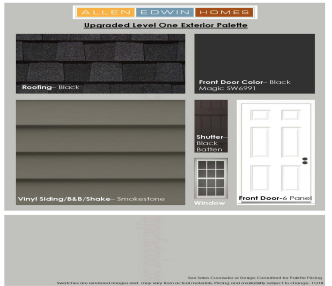
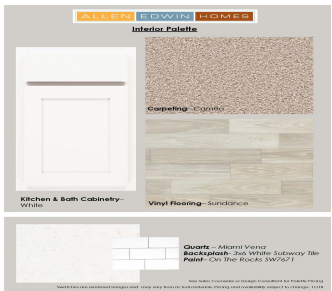

Coming Feb/March—your chance to own a brand-new Westwood Estates home in the Zeeland School District while enjoying Holland Twp taxes. This home is 49 years newer than local comps! Step onto the charming covered porch and into a sun-filled, open layout perfect for entertaining. The chef’s kitchen shines with quartz counters, island, tile backsplash, and [...]

- 4 beds
- 3 baths
- Single Family Residence
- Residential
- Active
- 1882 sq ft



Call us now

Phone: (231)730-8781

Email: tuckerbennerteam@gmail.com

Address: 2747 Lakeshore Drive, Twin Lake, MI 49457

Basics

Category: Residential

Status: Active

Bathrooms: 3 baths

Lot size: 0.21 sq ft

Subdivision Name: Westwood Estates

Lot Size Acres: 0.21 acres

County: Ottawa

Type: Single Family Residence

Bedrooms: 4 beds

Area: 1882 sq ft

Year built: 2025

Bathrooms Full: 2

Rooms Total: 9

Bathrooms Half: 1

Building Details

Building Area Total: 1882 sq ft

Architectural Style: Traditional

Heating: Forced Air

Roof: Composition, Shingle

Construction Materials: Vinyl Siding

Sewer: Public

Stories: 2

Basement: Daylight, Full

Amenities & Features

Laundry Features: Laundry Room, Main Level

Parking Features: Garage Faces Front, Garage Door Opener, Attached

WaterSource: Public

Interior Features: Garage Door Opener, Center Island, Eat-in Kitchen, Pantry

Patio And Porch Features: Deck, Porch(es)

Utilities: Natural Gas Connected

Garage Spaces: 2

Appliances: Dishwasher, Dryer, Microwave, Range, Refrigerator, Washer

Window Features: Low-Emissivity Windows, Screens

Cooling: Central Air, SEER 13 or Greater

Fees & Taxes

Call us now

Association Fee Frequency: Quarterly
Tax Year: 2025

Association Fee: \$150
Association Fee Includes: Other

School Information

High School District: Zeeland
Middle Or Junior School: Cityside Middle School
HighSchool: Zeeland East High School
Elementary School: Woodbridge Elementary School

Miscellaneous

Road Surface Type: Paved
Listing Terms: Cash, FHA, VA Loan, MSHDA, Conventional
CrossStreet: Ottogan St.

Call us now

 Phone: (231)730-8781
Email: tuckerbennerteam@gmail.com
Address: 2747 Lakeshore Drive, Twin Lake, MI 49457

