

CAYUGA, EVART, MI, 49631

https://tuckerbenner.com

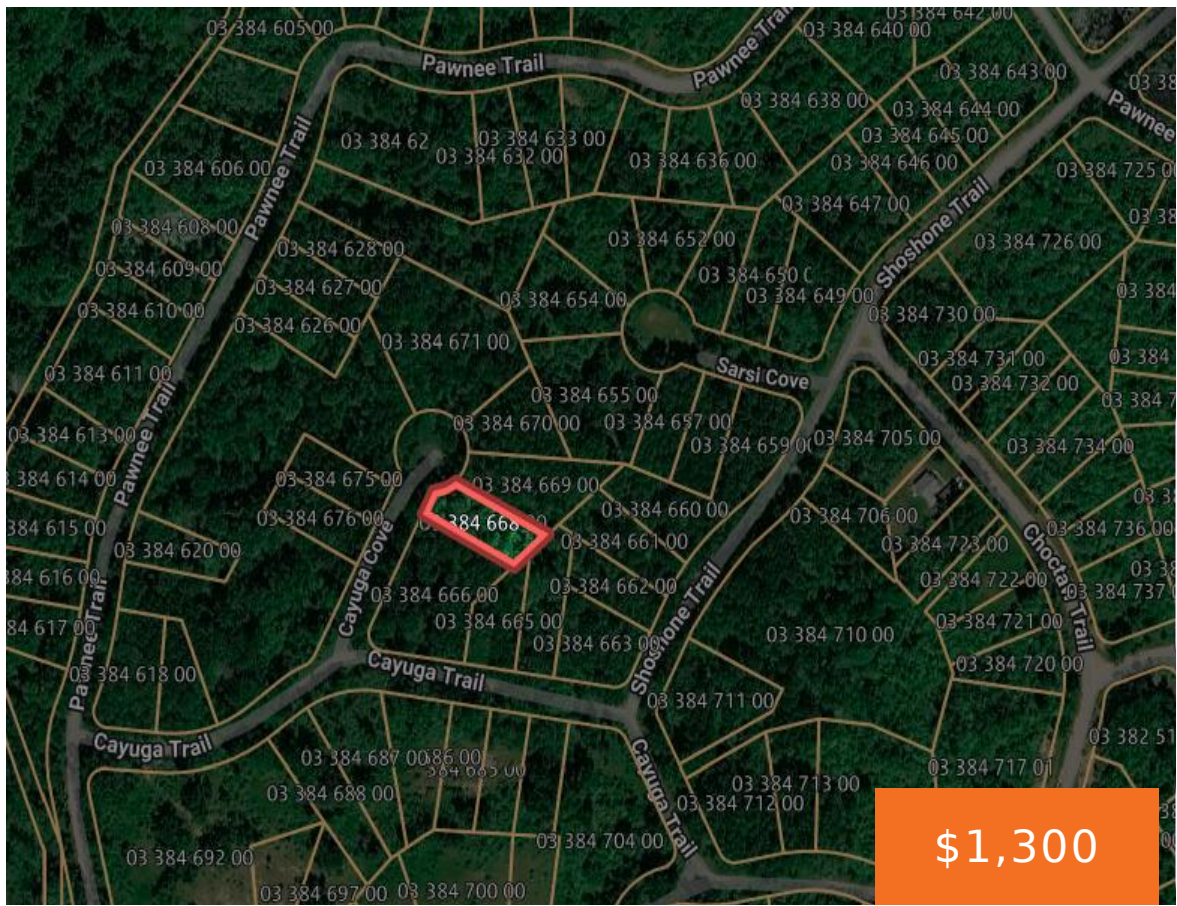

15 Vacant Lots in Lake Miramichi Association Excellent opportunity to own 15 vacant parcels located within the Lake Miramichi Association. These lots offer flexibility for a variety of uses, including future building sites, recreational use, or investment potential. Lots are available individually for \$600 each, or all 15 parcels may be purchased together for \$7,000. [...]

- 0 baths
- Lot
- Land
- Active



Basics

Category: Land
Status: Active
Lot size: 0.45 sq ft
Lot Size Acres: 0.45 acres

Type: Lot
Bathrooms: 0 baths
Subdivision Name: Lake Miramichi SUBD #4
County: Osceola

Call us now



Phone: (231)730-8781
 Email: tuckerbennerteam@gmail.com
 Address: 2747 Lakeshore Drive, Twin Lake, MI 49457



Amenities & Features

Utilities: Electricity Available, None **Association Amenities:** Beach Area, Campground, Boat Launch, Clubhouse

Waterfront Features: Lake

Lot Features: Wooded

Fees & Taxes

Tax Assessed Value: \$1,000

Association Fee Frequency: Annually

Association Fee: \$238

Tax Year: 2024

Tax Annual Amount: \$45.85

School Information

High School District: Ewart

Miscellaneous

CrossStreet: Shoshone Trail, Pawnee Trail

Listing Terms: Cash

Call us now



Phone: (231)730-8781

Email: tuckerbennerteam@gmail.com

Address: 2747 Lakeshore Drive, Twin Lake, MI 49457

