

# MC ALISTER, BENTON HARBOR, MI, 49022

<https://tuckerbenner.com>

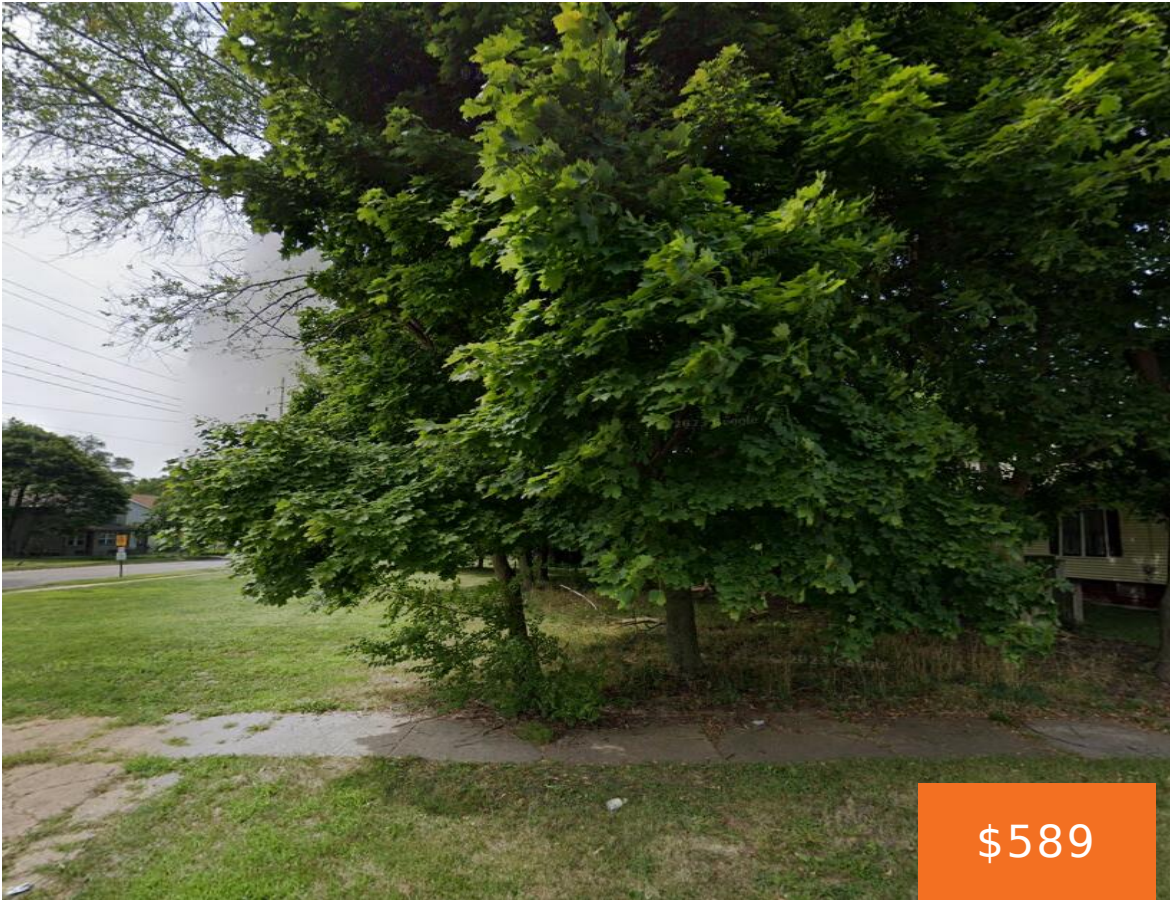

Excellent opportunity to build your dream home or investment project nestled in a neighborhood setting. Convenient easy access to local amenities, including the Benton Harbor Arts District, Harbor Shores Golf Course, and Lake Michigan’s beaches.

- 0 baths
- Lot
- Land
- Active



## Basics

**Category:** Land

**Status:** Active

**Lot size:** 0.03 sq ft

**County:** Berrien

**Type:** Lot

**Bathrooms:** 0 baths

**Lot Size Acres:** 0.03 acres



### Call us now

Phone: (231)730-8781  
 Email: [tuckerbennerteam@gmail.com](mailto:tuckerbennerteam@gmail.com)  
 Address: 2747 Lakeshore Drive, Twin Lake, MI 49457



---

## Building Details

**Current Use:** Residential

---

## Amenities & Features

**Utilities:** Phone Available, Water Available, Sewer Available, None

**Lot Features:** Level, Sidewalk

---

## Fees & Taxes

**Tax Assessed Value:** \$105

**Tax Year:** 2024

**Tax Annual Amount:** \$6

---

## School Information

**High School District:** Benton Harbor

---

## Miscellaneous

**Road Surface Type:** Paved

**CrossStreet:** Mc Alister St & W Empire

**Listing Terms:** Cash, Conventional



### Call us now

Phone: (231)730-8781

Email: [tuckerbennerteam@gmail.com](mailto:tuckerbennerteam@gmail.com)

Address: 2747 Lakeshore Drive, Twin Lake, MI 49457

