

# NADEAU, PULLMAN, MI, 49450

<https://tuckerbenner.com>

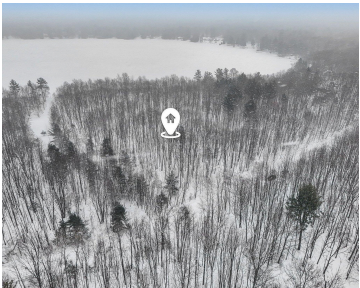
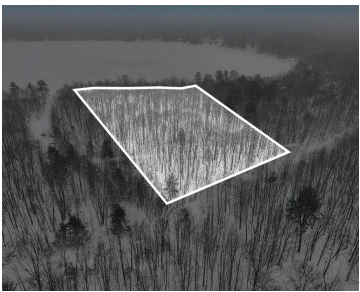
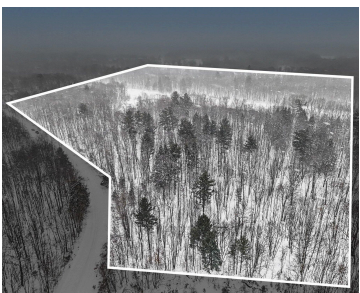

Beautiful 40-acre wooded parcel offering privacy, mature trees, and desirable lake access. This scenic property provides abundant wildlife, a peaceful natural setting, and ample space to build your dream home or private retreat. With its size and layout, the land also offers strong potential for future development (subject to zoning and approvals). A rare opportunity [...]

- 0 baths
- Acreage
- Land
- Active

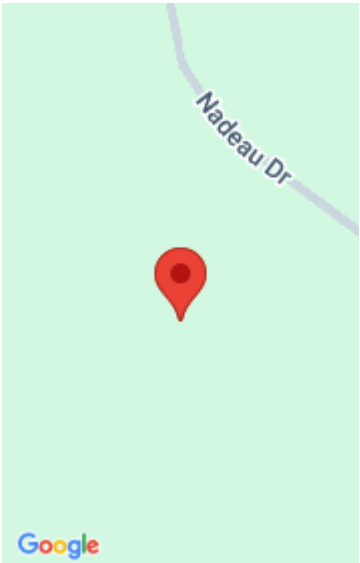

## Call us now

Phone: (231)730-8781  
Email: [tuckerbennerteam@gmail.com](mailto:tuckerbennerteam@gmail.com)  
Address: 2747 Lakeshore Drive, Twin Lake, MI 49457

---

# Basics

**Category:** Land

**Status:** Active

**Lot size:** 44.5 sq ft

**County:** Allegan

**Type:** Acreage

**Bathrooms:** 0 baths

**Lot Size Acres:** 44.5 acres

---

# Building Details

**Current Use:** Recreational, Hunting

---

# Amenities & Features

**Utilities:** Electricity Available, None   **Waterfront Features:** Lake, Stream/Creek  
**Lot Features:** Wooded

---

# Fees & Taxes

**Tax Assessed Value:** \$31,942

**Tax Annual Amount:** \$1,748.22

**Tax Year:** 2025

---

# School Information

**High School District:** Bloomingdale

---

# Miscellaneous

**Call us now**

**Road Surface Type:** Paved

**CrossStreet:** Nadeau Dr and 109th st

**Listing Terms:** Cash, Conventional

**Call us now**



Phone: (231)730-8781  
Email: tuckerbennerteam@gmail.com  
Address: 2747 Lakeshore Drive, Twin Lake, MI 49457

