

2, MARKRIDGE DRIVE, GRAND RAPIDS, MI, 49534

<https://tuckerbenner.com>

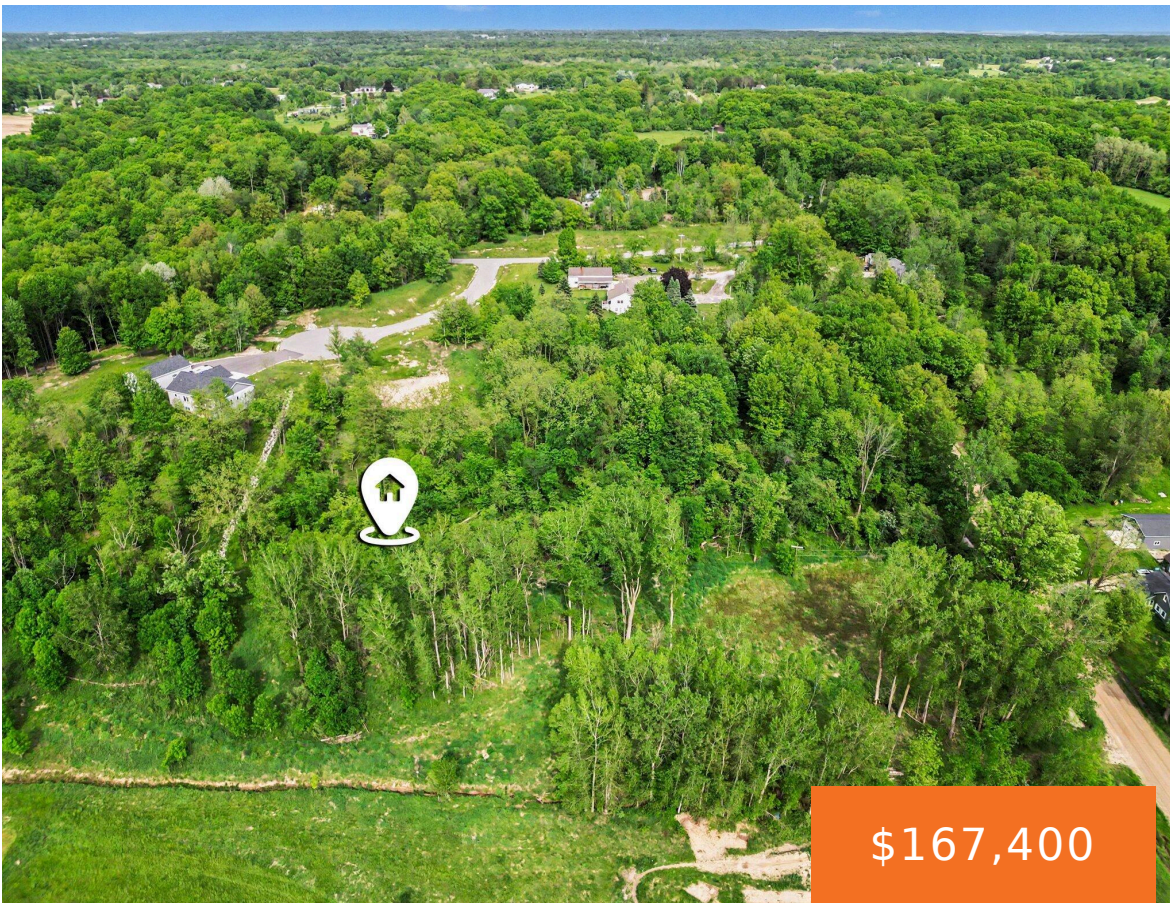

Welcome to Parcel 2 on Markridge—a beautiful rolling and wooded building site located in Tallmadge Township and within the highly regarded Grandville School District. This private lot sits on a newly paved cul-de-sac and offers natural gas, underground electric, and Spectrum high-speed internet. You're welcome to bring your own builder, and pole barns are permitted. [...]

- 0 baths
- Lot
- Land
- Active



Basics

Category: Land

Status: Active

Lot size: 2.72 sq ft

County: Ottawa

Type: Lot

Bathrooms: 0 baths

Lot Size Acres: 2.72 acres

Call us now



Phone: (231)730-8781

Email: tuckerbennerteam@gmail.com

Address: 2747 Lakeshore Drive, Twin Lake, MI 49457



Amenities & Features

Utilities: Natural Gas Available, Electricity Available, Cable Available, None

Lot Features: Rolling Hills, Buildable

Fees & Taxes

Tax Assessed Value: \$65,600

Tax Year: 2025

Tax Annual Amount: \$3,016.24

School Information

High School District: Grandville

Miscellaneous

Road Surface Type: Paved

CrossStreet: Winans St NW

Listing Terms: Cash, Conventional

Call us now



Phone: (231)730-8781

Email: tuckerbennerteam@gmail.com

Address: 2747 Lakeshore Drive, Twin Lake, MI 49457

