

WELDON, BEULAH, MI, 49617

https://tuckerbenner.com

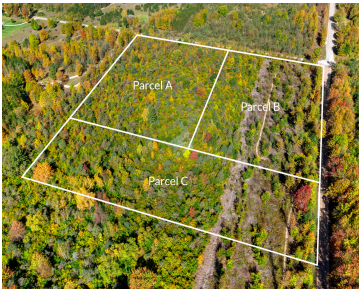
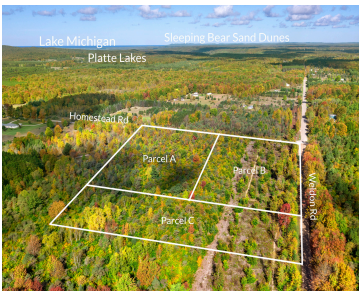

Discover your own piece of Northern Michigan paradise with this beautiful 5-acre parcel in scenic Benzie County. Offering the perfect blend of open and wooded land, this property provides flexibility for building, recreation, or simply enjoying the natural surroundings. The land has been surveyed and successfully perc tested—ready for your dream home or up-north getaway. [...]

- 0 baths
- Acreage
- Land
- Active

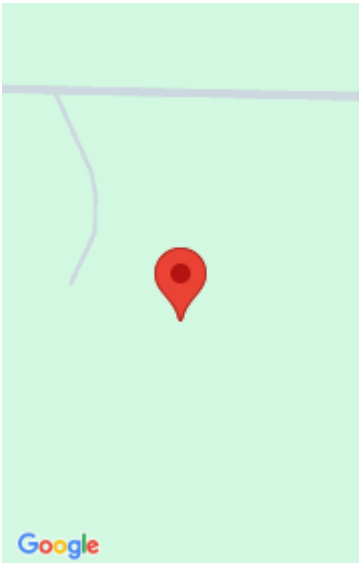

Call us now

Basics

Category: Land

Status: Active

Lot size: 5.05 sq ft

County: Benzie

Type: Acreage

Bathrooms: 0 baths

Lot Size Acres: 5.05 acres

Building Details

Sewer: Septic Tank

Current Use: Recreational, Hunting

Amenities & Features

Utilities: Electricity Available, None

WaterSource: Well

Lot Features: Level, Cleared, Wooded

Fees & Taxes

Tax Assessed Value: \$13,463

Tax Year: 2025

Tax Annual Amount: \$12,345,678

School Information

High School District: Benzie

Miscellaneous

CrossStreet: Homestead Rd

Listing Terms: Cash, Conventional

Call us now