

# RANGE, MEARS, MI, 49436

<https://tuckerbenner.com>

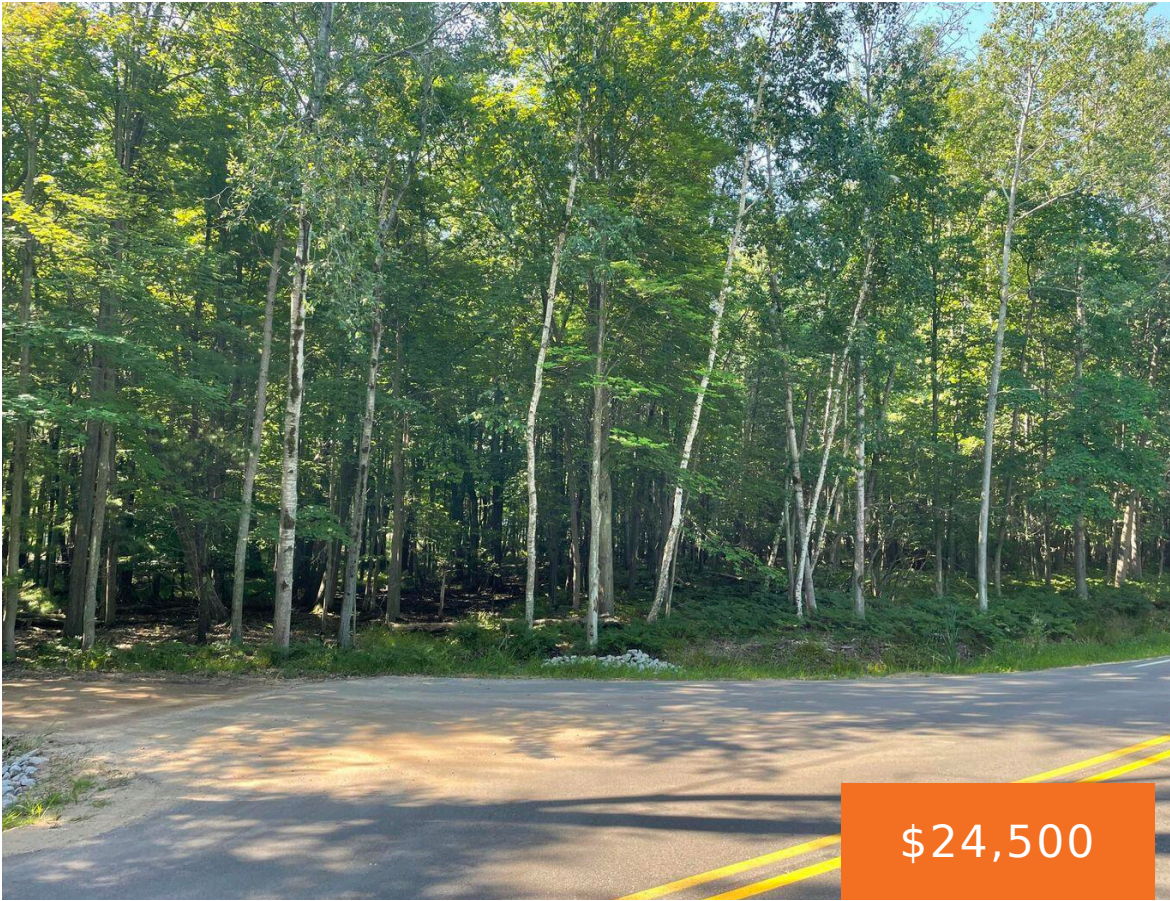

A Wooded building site just a short walk from your deeded Lake Michigan access. Enjoy a wide, sandy beach where you can relax, listen to the waves, and take in those iconic Lake Michigan sunsets. This location sits perfectly between Silver Lake and Pentwater, offering easy access to both communities. The lot has already been [...]

- 0 baths
- Lot
- Land
- Active



## Call us now



Phone: (231)730-8781  
Email: [tuckerbennerteam@gmail.com](mailto:tuckerbennerteam@gmail.com)  
Address: 2747 Lakeshore Drive, Twin Lake, MI 49457



---

## Basics

**Category:** Land

**Status:** Active

**Lot size:** 0.14 sq ft

**Lot Size Acres:** 0.14 acres

**Type:** Lot

**Bathrooms:** 0 baths

**Subdivision Name:** Lake MI Shores

**County:** Oceana

---

## Amenities & Features

**Utilities:** Electricity Available, None

**Waterfront Features:** Lake

**Association Amenities:** Beach Area

**Lot Features:** Buildable, Wooded

---

## Fees & Taxes

**Tax Year:** 2025

---

## School Information

**High School District:** Hart

---

## Miscellaneous

**Road Surface Type:** Unimproved

**Listing Terms:** Cash, Conventional

**CrossStreet:** N Ridge Road

### Call us now



Phone: (231)730-8781

Email: tuckerbennerteam@gmail.com

Address: 2747 Lakeshore Drive, Twin Lake, MI 49457

