

SILVER VISTA, MEARS, MI, 49436

https://tuckerbenner.com

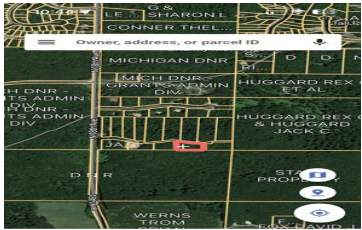

\$65,000



DANIEL KRISTAN A
 Owner
 Address
 006-655-002-00
 Parcel ID



Beautiful views on this lot that is adjacent to state land in a gated sub division. This buildable high elevation lot is adjacent to 80 acres of DNR land. Close to silver lake. Build the house and rent it or enjoy it! Land Contract terms available. Listing Agent is married to owner.

- 0 baths
- Lot
- Land
- Active



Basics

Category: Land

Status: Active

Lot size: 1.12 sq ft

Lot Size Acres: 1.12 acres

Type: Lot

Bathrooms: 0 baths

Subdivision Name: Silver Vista

County: Oceana



Call us now

Phone: (231)730-8781

Email: tuckerbennerteam@gmail.com

Address: 2747 Lakeshore Drive, Twin Lake, MI 49457



Building Details

Current Use: Residential, Recreational, Hunting

Amenities & Features

Utilities: None Connected,
Electric Available

Lot Features: Level, Ravine, High Bank, Adj to Public Land,
Buildable, Recreational, Wooded

Fees & Taxes

Tax Assessed Value: \$15,200

Tax Year: 2023

Tax Annual Amount: \$678

School Information

High School District: Shelby

Miscellaneous

Road Surface Type: Paved

CrossStreet: 18th avenue

Listing Terms: Cash, Conventional, Contract



Call us now

Phone: (231)730-8781

Email: tuckerbennerteam@gmail.com

Address: 2747 Lakeshore Drive, Twin Lake, MI 49457

