

SIMONELLI, MUSKEGON, MI, 49445

<https://tuckerbenner.com>

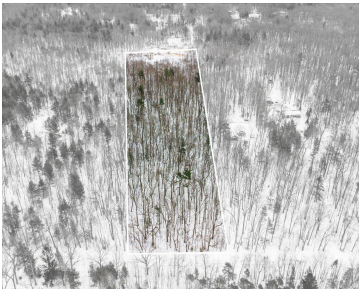

Here's your chance to own 10 acres in the highly desired Laketon Township. This buildable lot has many options and is ready for its new home. Close to Lake Michigan and other amenities such as schools, highway and restaurants yet far enough out to give you privacy and the ability to get away from the [...]

- 0 baths
- Acreage
- Land
- Active

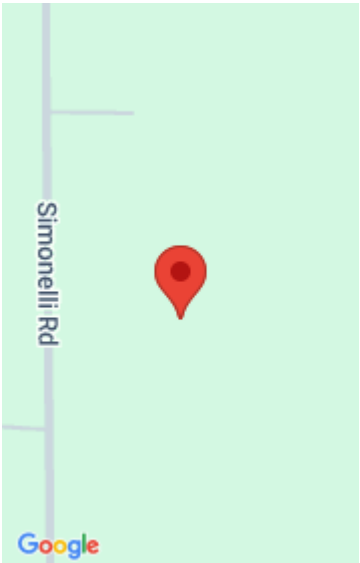

Call us now



Phone: (231)730-8781
Email: tuckerbennerteam@gmail.com
Address: 2747 Lakeshore Drive, Twin Lake, MI 49457



Basics

Category: Land

Status: Active

Lot size: 10.03 sq ft

County: Muskegon

Type: Acreage

Bathrooms: 0 baths

Lot Size Acres: 10.03 acres

Amenities & Features

Utilities: Natural Gas Available, Electricity Available, None

Lot Features: Buildable

Fees & Taxes

Tax Assessed Value: \$7,976

Tax Year: 2025

Tax Annual Amount: \$400.93

School Information

High School District: Reeths-Puffer

Miscellaneous

CrossStreet: W Giles & W River

Listing Terms: Cash, Conventional

Call us now