

# 10TH, SHELBYVILLE, MI, 49344

<https://tuckerbenner.com>

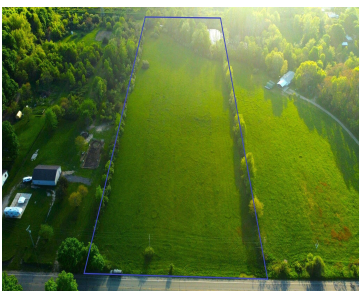

Take a look at this beautiful tree lined 7+ Acre Parcel minutes from US131! Great spot for building with some space, hobby farm, or for investment. Casino is nearby. Water/sewer is in the long term township plan. Rear property line butts up to utility property- piece of mind no building happening there. Tillable land - [...]

- 0 baths
- Acreage
- Land
- Active

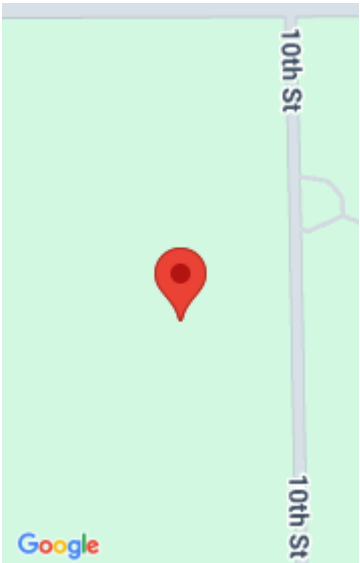

## Call us now



Phone: (231)730-8781

Email: [tuckerbennerteam@gmail.com](mailto:tuckerbennerteam@gmail.com)

Address: 2747 Lakeshore Drive, Twin Lake, MI 49457



# Basics

**Category:** Land

**Status:** Active

**Lot size:** 7.16 sq ft

**County:** Allegan

**Type:** Acreage

**Bathrooms:** 0 baths

**Lot Size Acres:** 7.16 acres

# Building Details

**Current Use:** Agricultural

# Amenities & Features

**Utilities:** Phone Available, None

**Lot Features:** Buildable, Cleared, Tillable

# Fees & Taxes

**Tax Assessed Value:** \$29,908

**Tax Year:** 2024

**Tax Annual Amount:** \$1,438.47

# School Information

**High School District:** Wayland

# Miscellaneous

**Road Surface Type:** Paved

**CrossStreet:** 129th Ave & 10th St

**Listing Terms:** Cash, Conventional

## Call us now