

HOLTON, MUSKEGON, MI, 49445

<https://tuckerbenner.com>

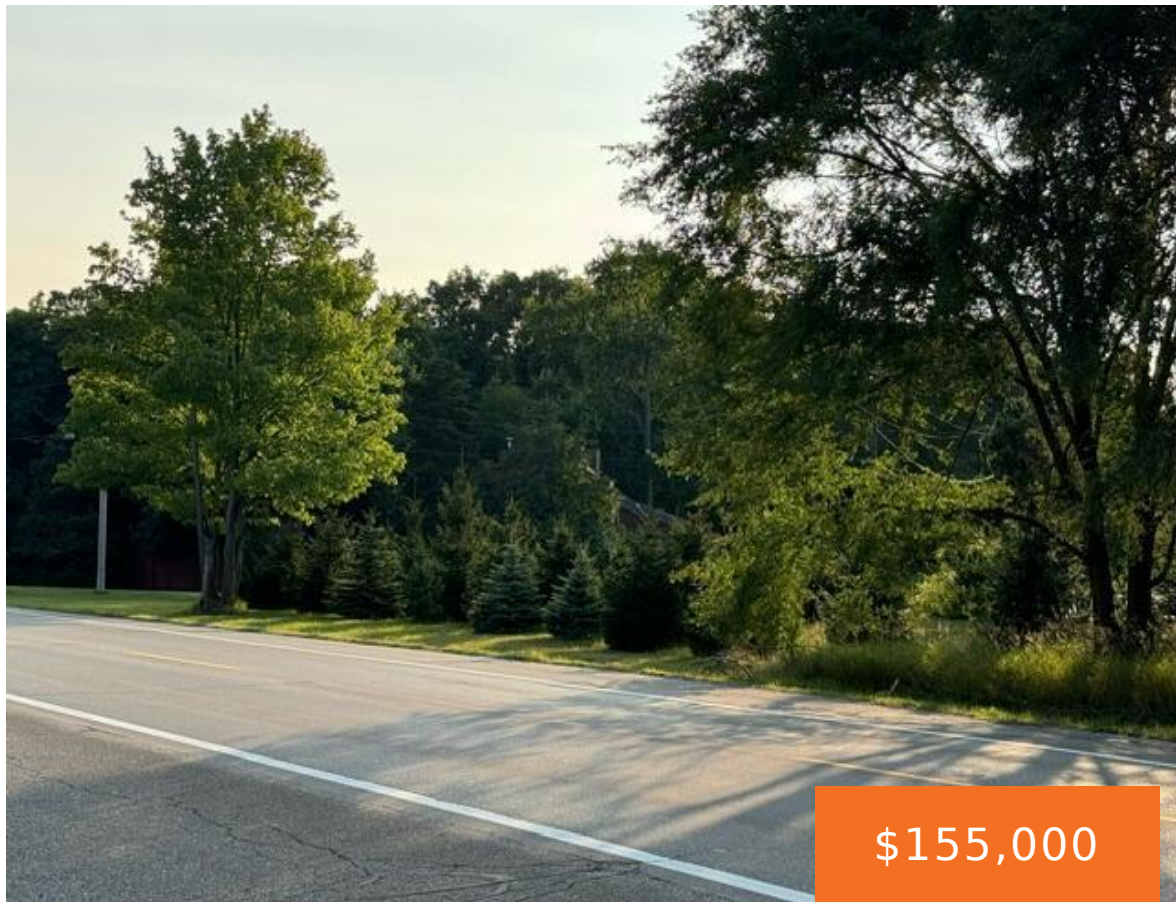

This exceptional 1.45 acre (3 parcels) of vacant land offers the ideal setting for your future home or investment. Situated conveniently close to major roads and just minutes from essential amenities, this property combines the tranquility of open space with the convenience of nearby shopping, dining, and recreational options. Whether you're dreaming of a custom-built [...]

- 0 baths
- Acreage
- Land
- Active



Call us now



Phone: (231)730-8781
Email: tuckerbennerteam@gmail.com
Address: 2747 Lakeshore Drive, Twin Lake, MI 49457



Basics

Category: Land

Status: Active

Lot size: 1.45 sq ft

County: Muskegon

Type: Acreage

Bathrooms: 0 baths

Lot Size Acres: 1.45 acres

Building Details

Current Use: Residential

Amenities & Features

Utilities: Natural Gas Available, Electricity Available, Cable Available, Phone Available, None

Lot Features: Level, Buildable, Cleared, Corner Lot

Fees & Taxes

Tax Assessed Value: \$400

Tax Year: 2023

Tax Annual Amount: \$400

School Information

High School District: Reeths-Puffer

Miscellaneous

CrossStreet: KOONSMAN

Listing Terms: Cash, Conventional, Contract

Call us now



Phone: (231)730-8781

Email: tuckerbennerteam@gmail.com

Address: 2747 Lakeshore Drive, Twin Lake, MI 49457

