

5811, 108TH AVE, PULLMAN, MI, 49450

<https://tuckerbenner.com>

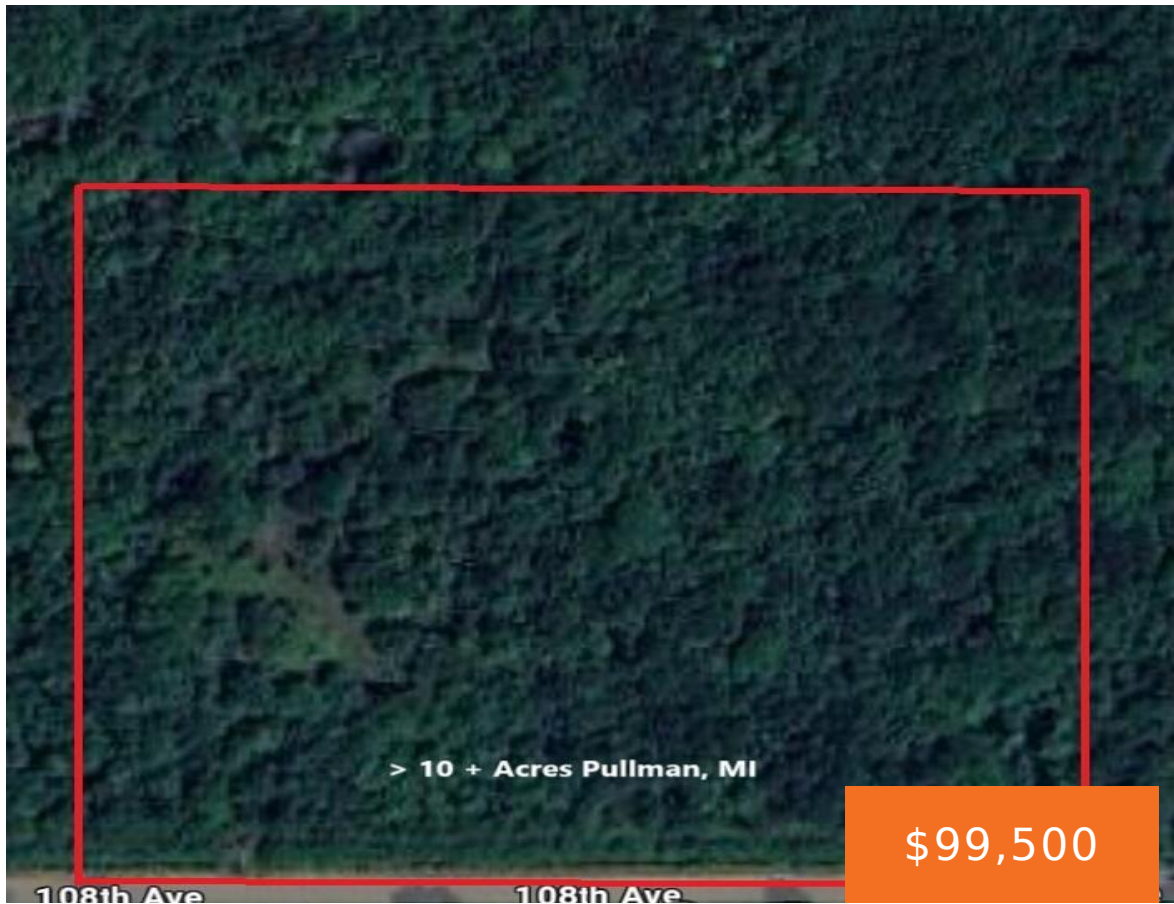

Here is your opportunity to own a nicely wooded private 10+ acre parcel just outside the town of Pullman Michigan. Mature oaks can be found throughout the property and deer sign was heavy as you can see from the pictures! Just a short drive from South Haven for shopping and beaches or Allegan State Game [...]

- 0 baths
- Commercial Land
- Land
- Active



Basics

Category: Land

Status: Active

Lot size: 10.01 sq ft

County: Allegan

Type: Commercial Land

Bathrooms: 0 baths

Lot Size Acres: 10.01 acres



Call us now

Phone: (231)730-8781
 Email: tuckerbennerteam@gmail.com
 Address: 2747 Lakeshore Drive, Twin Lake, MI 49457



Building Details

Current Use: Residential, Recreational, Hunting

Amenities & Features

Utilities: None

Lot Features: Level, Buildable, Recreational, Wooded

Fees & Taxes

Tax Assessed Value: \$16,868

Tax Year: 2024

Tax Annual Amount: \$969.73

School Information

High School District: Bloomingdale

Miscellaneous

Road Surface Type: Unimproved **CrossStreet:** 108TH AVE and 60TH ST

Listing Terms: Cash, Conventional



Call us now

Phone: (231)730-8781

Email: tuckerbennerteam@gmail.com

Address: 2747 Lakeshore Drive, Twin Lake, MI 49457

