

BASELINE, GRAND JUNCTION, MI, 49056

https://tuckerbenner.com

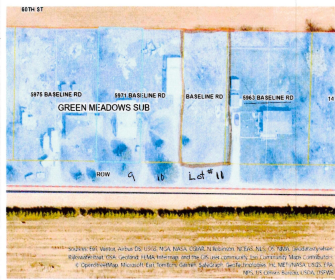

\$29,900



Build your dream home on this affordable residential lot in the desirable Green Meadows Subdivision. Conveniently located just 17 minutes from South Haven, you'll enjoy easy access to Lake Michigan beaches, restaurants, a movie theater, marinas, and the summer farmers market, as well as a skating rink in the winter. South Haven is also known [...]

- 0 baths
- Lot
- Land
- Active



Call us now

Phone: (231)730-8781
 Email: tuckerbennerteam@gmail.com
 Address: 2747 Lakeshore Drive, Twin Lake, MI 49457



Basics

Category: Land

Type: Lot

Status: Active

Bathrooms: 0 baths

Lot size: 0.25 sq ft

Subdivision Name: Green Meadows Subdivision

Lot Size Acres: 0.25 acres

County: Allegan

Building Details

Current Use: Residential

Amenities & Features

Utilities: Electricity Available, None

Lot Features: Level, Buildable

Fees & Taxes

Tax Assessed Value: \$866

Tax Year: 2025

Tax Annual Amount: \$46.58

School Information

High School District: Bloomingdale

Miscellaneous

CrossStreet: 59th & 60th

Listing Terms: Cash, Conventional

Call us now



Phone: (231)730-8781

Email: tuckerbennerteam@gmail.com

Address: 2747 Lakeshore Drive, Twin Lake, MI 49457

