

# BASS LAKE RD, HOWARD CITY, MI, 49329

<https://tuckerbenner.com>

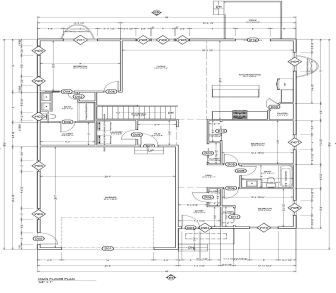

Here is your opportunity to have a turn key new build in Howard City. Everything is included with the purchase price including well/septic. Home will be completed on the upper level with room to finish the basement to add equity in the future. This is your one stop shop for a completely new home for [...]

- 3 beds
- 2 baths
- Single Family Residence
- Residential
- Active
- 1700 sq ft



## Basics



### Call us now

Phone: (231)730-8781  
Email: [tuckerbennerteam@gmail.com](mailto:tuckerbennerteam@gmail.com)  
Address: 2747 Lakeshore Drive, Twin Lake, MI 49457



**Category:** Residential

**Status:** Active

**Bathrooms:** 2 baths

**Lot size:** 3 sq ft

**Bathrooms Full:** 2

**Rooms Total:** 6

**Type:** Single Family Residence

**Bedrooms:** 3 beds

**Area:** 1700 sq ft

**Year built:** 2024

**Lot Size Acres:** 3 acres

**County:** Montcalm

---

## Building Details

**Building Area Total:** 1700 sq ft

**Architectural Style:** Ranch

**Heating:** Forced Air

**Basement:** Full

**Construction Materials:** Vinyl Siding

**Sewer:** Septic System

**Stories:** 1

---

## Amenities & Features

**Laundry Features:** Laundry Room, Main Level

**Parking Features:** Garage Faces Front, Attached

**WaterSource:** Well

**Interior Features:** Kitchen Island, Eat-in Kitchen, Pantry

**Exterior Features:** Deck(s)

**Utilities:** Phone Available, Electricity Available

**Garage Spaces:** 2

**Appliances:** Dishwasher, Range, Refrigerator

**Lot Features:** Level, Wooded

**Cooling:** Central Air

---

## Fees & Taxes

**Tax Year:** 2024

---

## School Information



### Call us now

Phone: (231)730-8781

Email: tuckerbennerteam@gmail.com

Address: 2747 Lakeshore Drive, Twin Lake, MI 49457



**High School District:** Tri County

---

## Miscellaneous

**CrossStreet:** Lake Montcalm & W Kendaville

**Listing Terms:** Cash, Conventional



### Call us now

Phone: (231)730-8781

Email: [tuckerbennerteam@gmail.com](mailto:tuckerbennerteam@gmail.com)

Address: 2747 Lakeshore Drive, Twin Lake, MI 49457

