

AVE, BATTLE CREEK, MI, 49017

<https://tuckerbenner.com>

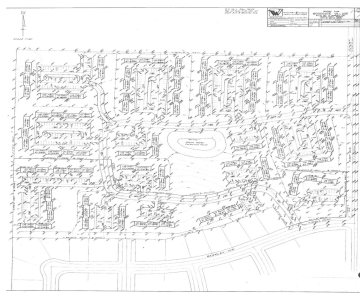

Welcome to Woodgate Village, an exclusive 26-acre gem nestled in Battle Creek. This unique development utilizes a Community Unit Plan (CUP), which enables a density of 9.2 units per acre, allowing for a total of 241 units. The project is unfolding in stages, with Phase I featuring 8 buildings and 54 units ready to go. [...]

- 0 baths
- Acreage
- Land
- Active



Basics

Category: Land

Status: Active

Lot size: 25.97 sq ft

Lot Size Acres: 25.97 acres

Type: Acreage

Bathrooms: 0 baths

Subdivision Name: Woodgate

County: Calhoun



Call us now

Phone: (231)730-8781
 Email: tuckerbennerteam@gmail.com
 Address: 2747 Lakeshore Drive, Twin Lake, MI 49457



Building Details

Current Use: Residential

Amenities & Features

Utilities: Phone Available, Storm Sewer, Water Available, Sewer Available, Natural Gas Available, Electricity Available, Cable Available, Water Connected, Sewer Connected

Lot Features: Level, Rolling Hills, Site Condo, Buildable, Wooded, Corner Lot

Fees & Taxes

Tax Assessed Value: \$48,350

Tax Year: 2023

Tax Annual Amount: \$3,102.23

School Information

High School District: Battle Creek

Miscellaneous

Road Surface Type: Unimproved

CrossStreet: Berkley & Morgan

Listing Terms: Cash, Tax Def Exchange, Purchase Money Mtg, Conventional, Contract



Call us now

Phone: (231)730-8781

Email: tuckerbennerteam@gmail.com

Address: 2747 Lakeshore Drive, Twin Lake, MI 49457

