

LEVELY, RHODES, MI, 48652

<https://tuckerbenner.com>

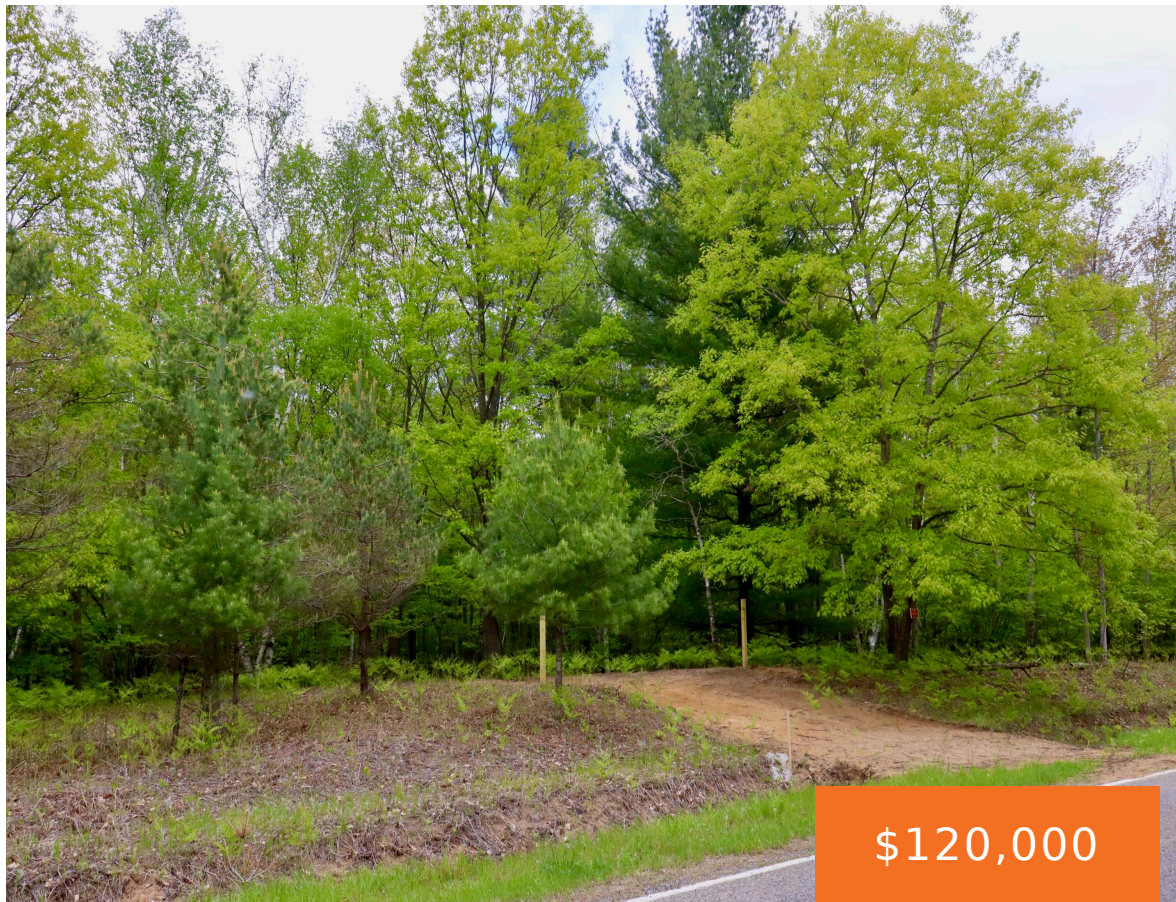

Discover this 20-acre parcel offering a combination of privacy, natural beauty and convenience. Ideally suited for a dream home or recreational retreat, the property features a dense mix of mature hardwoods and towering white pines, offering a quiet, naturally beautiful environment. With 330 feet of frontage along paved E. Levely Road, the site provides easy [...]

- 0 baths
- Acreage
- Land
- Active

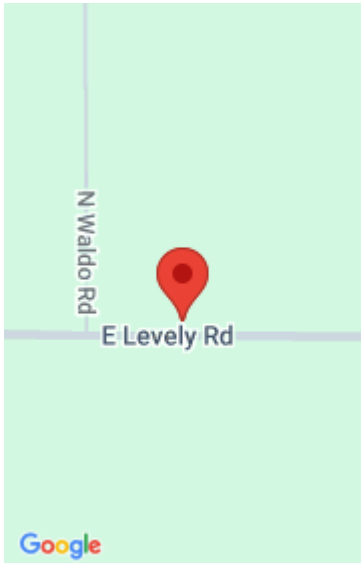

Basics

Category: Land

Status: Active

Lot size: 20 sq ft

County: Midland

Type: Acreage

Bathrooms: 0 baths

Lot Size Acres: 20 acres

Building Details

Current Use: Recreational, Hunting

Amenities & Features

Utilities: Electricity Available, None

Lot Features: Buildable, Recreational, Wooded

Fees & Taxes

Tax Assessed Value: \$20,077

Tax Year: 2025

Tax Annual Amount: \$1,100

School Information

High School District: Midland

Miscellaneous

Road Surface Type: Paved

CrossStreet: E Levely Road

Listing Terms: Cash, Conventional

Call us now