

WILDWOOD WAY LOT B, HASTINGS, MI, 49058

<https://tuckerbenner.com>

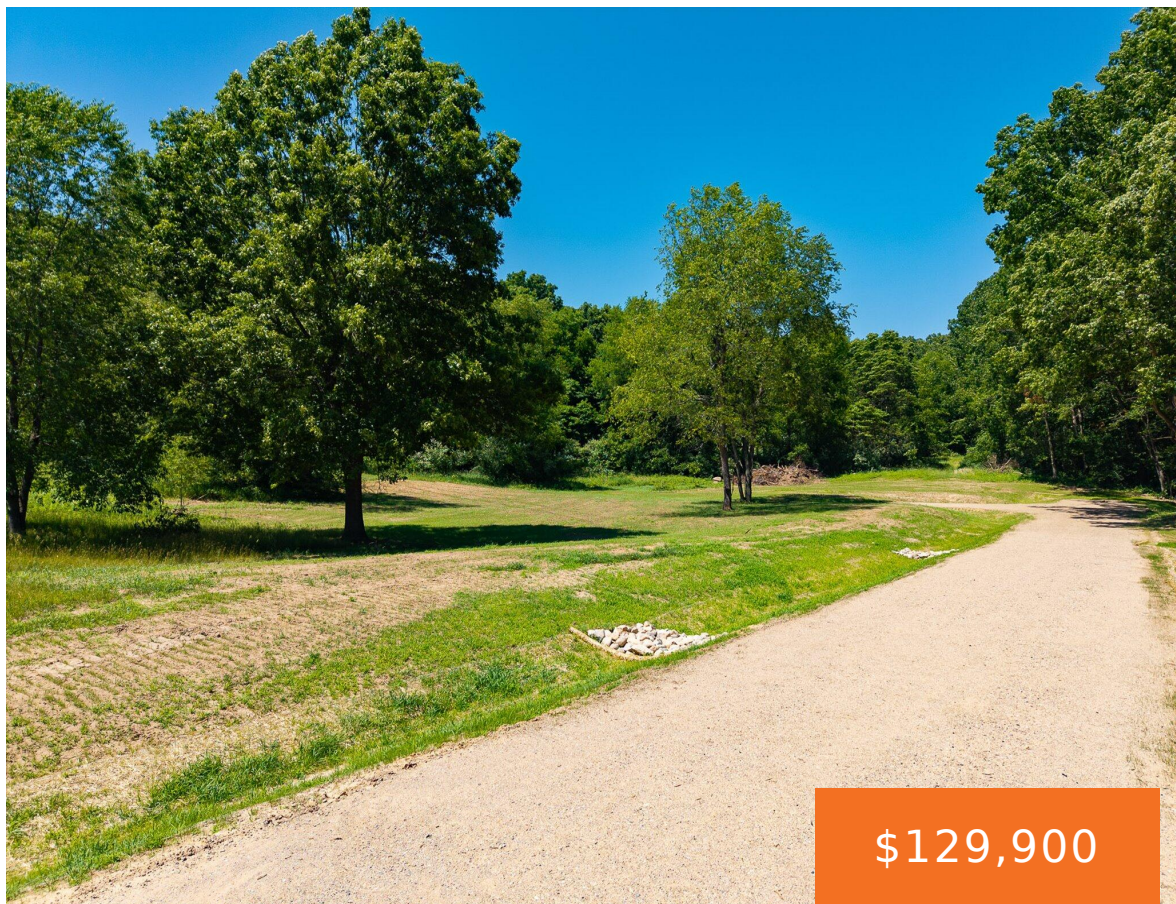

\$129,900

Welcome to this private 5 acre parcel set back off Ryan Road and accessed by the newly constructed private drive, Wildwood Way. This property offers a quiet, secluded setting with rolling terrain ideal for a future home, cabin, or recreational retreat. Wildlife is plentiful, deer and turkey are commonly seen throughout the property, creating a [...]



- 0 baths
- Acreage
- Land
- Active

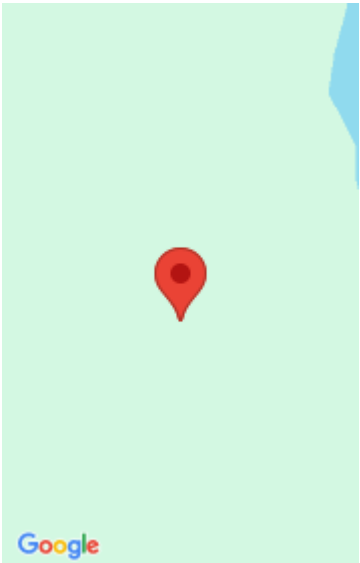

Call us now



Phone: (231)730-8781

Email: tuckerbennerteam@gmail.com

Address: 2747 Lakeshore Drive, Twin Lake, MI 49457



Basics

Category: Land

Status: Active

Lot size: 5 sq ft

County: Barry

Type: Acreage

Bathrooms: 0 baths

Lot Size Acres: 5 acres

Building Details

Current Use: Recreational, Hunting

Amenities & Features

Utilities: Electricity Available, None

Lot Features: Rolling Hills, Buildable, Building, Recreational, Wooded

Fees & Taxes

Tax Assessed Value: \$175,200

Tax Annual Amount: \$2,600.52

Tax Year: 2024

School Information

High School District: Thornapple Kellogg

Miscellaneous

Call us now



Phone: (231)730-8781

Email: tuckerbennerteam@gmail.com

Address: 2747 Lakeshore Drive, Twin Lake, MI 49457



Road Surface Type: Unimproved

CrossStreet: Ryan Rd

Listing Terms: Cash, Conventional

Call us now



Phone: (231)730-8781
Email: tuckerbennerteam@gmail.com
Address: 2747 Lakeshore Drive, Twin Lake, MI 49457

