

BALL, HILLSDALE, MI, 49242

<https://tuckerbenner.com>

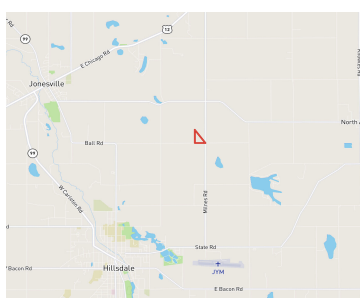
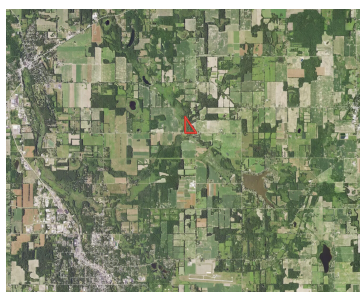

Explore the potential of this 24 +/- acre parcel just outside Jonesville and Hillsdale, MI. This mostly wooded property offers a rich tapestry of natural beauty and recreational opportunities. Whether you're into camping, hunting, bird watching, or simply enjoying the great outdoors, this land has it all. Nestled in the heart of the property is [...]

- 0 baths
- Acreage
- Land
- Active



Basics

Category: Land

Status: Active

Lot size: 23.78 sq ft

County: Hillsdale

Type: Acreage

Bathrooms: 0 baths

Lot Size Acres: 23.78 acres



Call us now

Phone: (231)730-8781
 Email: tuckerbennerteam@gmail.com
 Address: 2747 Lakeshore Drive, Twin Lake, MI 49457



Building Details

Current Use: Recreational, Hunting

Amenities & Features

Utilities: Electricity Available, None

Lot Features: Recreational, Wooded, Corner Lot

Fees & Taxes

Tax Assessed Value: \$44,600

Tax Year: 2023

Tax Annual Amount: \$1,828.09

School Information

High School District: Hillsdale

Miscellaneous

Road Surface Type: Unimproved **CrossStreet:** Milnes & Half Moon Lake

Listing Terms: Cash, Conventional



Call us now

Phone: (231)730-8781

Email: tuckerbennerteam@gmail.com

Address: 2747 Lakeshore Drive, Twin Lake, MI 49457

