

ELLEN, DOWAGIAC, MI, 49047

<https://tuckerbenner.com>

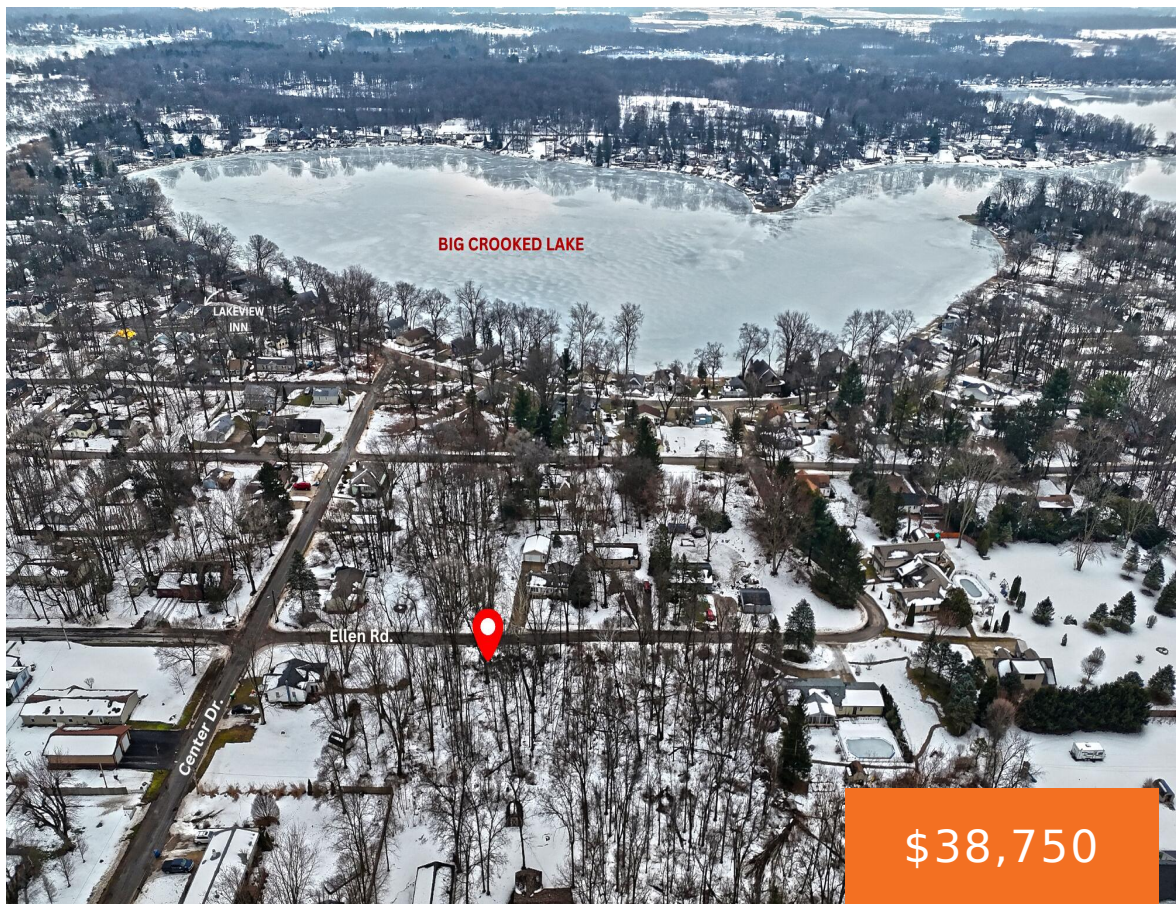

Discover the perfect spot to build your dream getaway in the charming Sister Lakes community! This wooded lot is nestled in a quaint neighborhood, offering a serene setting while keeping you close to everything that makes this area special. Enjoy being just a short walk to Big Crooked Lake, where you can take in the [...]

- 0 baths
- Lot
- Land
- Active

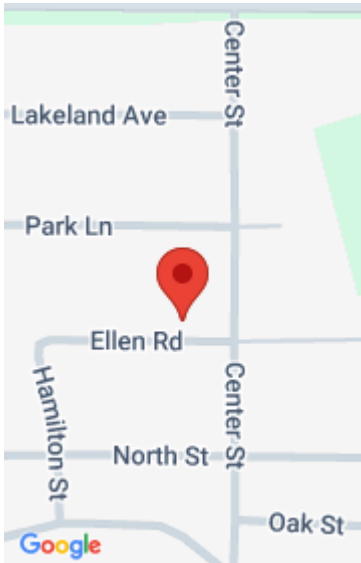

Call us now

Phone: (231)730-8781
Email: tuckerbennerteam@gmail.com
Address: 2747 Lakeshore Drive, Twin Lake, MI 49457

Basics

Category: Land
Status: Active
Lot size: 0.49 sq ft
County: Van Buren

Type: Lot
Bathrooms: 0 baths
Lot Size Acres: 0.49 acres

Amenities & Features

Utilities: Natural Gas Available, Electricity Available, Cable Available, None

Interior Features: Broadband

Waterfront Features:
Lake

Fees & Taxes

Tax Assessed Value: \$5,263

Tax Annual Amount: \$248

Tax Year: 2024

School Information

High School District: Dowagiac

Miscellaneous

Road Surface Type: Paved

Listing Terms: Cash, Conventional

CrossStreet: Center & Hamilton

Call us now

Phone: (231)730-8781
Email: tuckerbennerteam@gmail.com
Address: 2747 Lakeshore Drive, Twin Lake, MI 49457