

KROFFT, MUNITH, MI, 49259

<https://tuckerbenner.com>

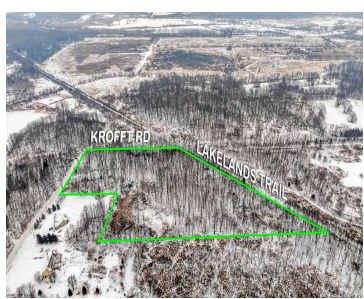

Looking for Hunting Land? This 11.41-acre heavily wooded parcel in Henrietta Township, Northwest Schools could be it. This property is full of hardwoods with maple & oak trees, an incredible setting for a new home on the South & East side of property. The North and West Side of property you will find swale. There [...]

- 0 baths
- Acreage
- Land
- Active



Basics

Category: Land

Status: Active

Lot size: 11.41 sq ft

County: Jackson

Type: Acreage

Bathrooms: 0 baths

Lot Size Acres: 11.41 acres



Call us now

Phone: (231)730-8781
 Email: tuckerbennerteam@gmail.com
 Address: 2747 Lakeshore Drive, Twin Lake, MI 49457



Building Details

Current Use: Recreational, Hunting

Amenities & Features

Utilities: None

Lot Features: Rolling Hills, High Bank, Wooded

Fees & Taxes

Tax Assessed Value: \$18,275

Tax Year: 2024

Tax Annual Amount: \$676.60

School Information

High School District: Northwest

Miscellaneous

Road Surface Type: Paved

CrossStreet: Wooster & Coonhill

Listing Terms: Cash, Conventional



Call us now

Phone: (231)730-8781

Email: tuckerbennerteam@gmail.com

Address: 2747 Lakeshore Drive, Twin Lake, MI 49457

