

LEYTONSTONE, WEST BLOOMFIELD, MI, 48322

<https://tuckerbenner.com>

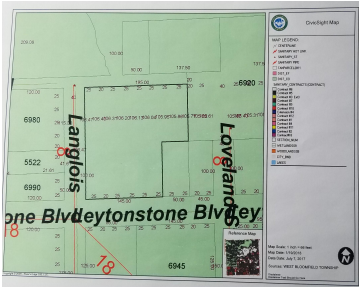
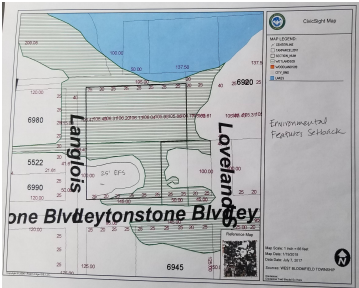

Lake front parcel located in West Bloomfield with award winning Walled Lake schools. Perfect opportunity to build your dream home.

- 0 baths
- Lot
- Land
- Active



Call us now

Phone: (231)730-8781
Email: tuckerbennerteam@gmail.com
Address: 2747 Lakeshore Drive, Twin Lake, MI 49457

Basics

Category: Land

Status: Active

Lot size: 0.81 sq ft

County: Oakland

Type: Lot

Bathrooms: 0 baths

Lot Size Acres: 0.81 acres

Building Details

Current Use: Residential

Amenities & Features

Utilities: Sewer Available, Natural Gas Available, Electricity Available, Cable Available, None

Waterfront Features: Lake

Fees & Taxes

Tax Assessed Value: \$8,284

Tax Year: 2023

Tax Annual Amount: \$367

School Information

High School District: Walled Lake

Miscellaneous

CrossStreet: Walnut Lake Rd & Halsted Rd

Listing Terms: Cash, Conventional, Contract

Call us now



Phone: (231)730-8781

Email: tuckerbennerteam@gmail.com

Address: 2747 Lakeshore Drive, Twin Lake, MI 49457

